

Heller

FCM 36

30322



DÉCOUVREZ LE MONDE DES PEINTURES ACRYLIQUES HELLER !

DISCOVER THE WORLD OF HELLER ACRYLIC PAINTS!
ENTDECKEN SIE DIE WELT DER HELLER ACRYL-FARBEN!

NEW



- FACILE À UTILISER
- DILUABLE À L'EAU
- POTS DE PEINTURE STABLES
- BOUCHON À VIS SÉCURISÉ

- EASY TO USE
- DILUTABLE WITH WATER
- STABLE PAINT CANS
- SECURE SCREW CAP

- EINFACHE ANWENDUNG
- MIT WASSER VERDÜNNBAR
- STANDFESTE FARBDOSEN
- SICHERER SCHRAUBVERSCHLUSS

Français

Char léger français de la Seconde Guerre mondiale

Le FCM 36 ou Char léger Modèle 1936 FCM était un char d'infanterie léger développé pour l'armée française juste avant la Seconde Guerre mondiale. Construit par les Forges et Chantiers de la Méditerranée (FCM), il s'agissait à l'époque d'un char d'infanterie léger français moderne. Doté d'un équipage de deux personnes il était équipé d'un canon court de 37 mm et d'une mitrailleuse coaxiale de 7,5 mm . Il était propulsé par un moteur diesel, mais sa conception et sa technologie étaient inférieures à celles de certains chars allemands de l'époque.

Le FCM 36 a participé aux batailles franco-allemandes de mai/juin 1940.

Après la défaite de la France à l'été 1940, de nombreux blindés français tombent aux mains de la Wehrmacht. Ils ont ensuite été utilisés dans diverses opérations de combat, mais aussi comme matériel de soutien et d'entraînement.

Parmi les véhicules capturés, on trouve des chars FCM 36, qui appartenaient auparavant à deux bataillons de chars français. Au total, la Wehrmacht en reçut 50. Nombre d'entre eux serviront plus tard de base à la construction d'obusiers automoteurs et de canons antichars.

English

WWII French Light Tank

The FCM 36 or Char léger Modèle 1936 FCM was a light infantry tank developed for the French Army just before the Second World War. Built by Forges et Chantiers de la Méditerranée (FCM), it was a modern French light infantry tank at the time. With a crew of two, it was equipped with a 37 mm short gun and a 7.5mm coaxial machine gun. It was powered by a diesel engine but was conceptually and technologically inferior to some of the German tanks of the time.

The FCM 36 took part in the Franco-German battles of May/June 1940.

After the defeat of France in the summer of 1940, many French armoured vehicles fell into the hands of the Wehrmacht. They were subsequently used in various combat operations, but also as support and training equipment.

Among the vehicles captured were FCM 36 tanks, which had previously belonged to two French tank battalions. In all, the Wehrmacht received 50 of them. Many of them later served as the basis for the construction of self-propelled howitzers and anti-tank guns.

Deutsch

Leichter französischer Panzer aus dem Zweiten Weltkrieg

Der FCM 36 oder Char léger Modèle 1936 FCM war ein leichter Infanteriepanzer, der kurz vor dem Zweiten Weltkrieg für die französische Armee entwickelt wurde. Er war von der Firma Forges et Chantiers de la Méditerranée (FCM) gebauter und seinerzeit moderner, leichter französischer Infanterie-Panzer. Er hatte zwei Mann Besatzung und war mit einer kurzen 37 mm Kanone und einem 7,5 mm Koaxial-Maschinengewehr ausgerüstet. Der Antrieb erfolgte durch einen Dieselmotor, jedoch war er einigen deutschen Panzertypen dieser Zeit konzeptionell und technologisch unterlegen.

Der FCM 36 nahm an den deutsch-französischen Kämpfen im Mai/Juni 1940 teil.

Zahlreiche französische Panzerfahrzeuge fielen nach der Niederlage Frankreichs im Sommer 1940 in die Hände der Wehrmacht. Sie wurden anschließend in verschiedenen Kampfeinsätzen, aber auch als Hilfs- und Ausbildungsgeräte verwendet.

Unter den damals erbeuteten Panzerfahrzeugen befanden sich auch die FCM 36 Panzer, die zuvor zwei französischen Panzerbataillonen gehörten. Insgesamt erhielt die Wehrmacht davon 50 Stück. Viele von ihnen dienten später als Basis für den Bau von Panzerhaubitzen und Panzerabwehrkanonen.

Español

Tanque ligero francés de la Segunda Guerra Mundial

El FCM 36 o Tanque ligero Modelo 1936 FCM era un tanque de infantería ligero desarrollado para el ejército francés justo antes de la Segunda Guerra Mundial. Construido por Les Forges et Chantiers de la Méditerranée (FCM), en ese momento era un moderno tanque de infantería ligero francés. Con una dotación de dos personas, estaba equipado con un cañón corto de 37 mm y una ametralladora coaxial de 7,5 mm. Estaba propulsado por un motor diésel, pero su diseño y tecnología eran inferiores a los de algunos tanques alemanes de la época.

El FCM 36 participó en las batallas franco-alemanas de mayo/junio de 1940.

Después de la derrota de Francia en el verano de 1940, muchos tanques franceses cayeron en manos de la Wehrmacht. Posteriormente, se utilizaron en diversas operaciones de combate, pero también como material de apoyo y entrenamiento.

Entre los vehículos capturados, se encuentran tanques FCM 36, que anteriormente pertenecían a dos batallones de tanques franceses. En total, la Wehrmacht recibió 50 unidades. Muchos de ellos servirán más tarde de base para la construcción de obuses autopropulsados y cañones antitanque.

Italiano

Carro leggero francese della Seconda Guerra mondiale

Il FCM 36 o Carro leggero Modello 1936 FCM era un carro leggero di fanteria sviluppato per l'esercito francese poco prima della Seconda Guerra mondiale. Costruito dalle Forges et Chantiers de la Méditerranée (FCM), all'epoca era un moderno carro di fanteria leggera francese. Dotato di un equipaggio di due persone era dotato di un cannone corto da 37 mm e di una mitragliatrice coassiale da 7,5 mm. Era alimentato da un motore diesel, ma la sua concezione e la sua tecnologia erano inferiori a quelli di alcuni carri armati tedeschi dell'epoca.

Il FCM 36 ha partecipato alle battaglie franco-tedesche di maggio/giugno 1940.

Dopo la sconfitta della Francia nell'estate del 1940, molti blindati francesi sono caduti nelle mani della Wehrmacht e sono stati utilizzati in varie operazioni di combattimento, ma anche come mezzi di supporto e addestramento.

Tra i veicoli presi vi erano carri armati FCM 36 appartenuti a due battaglioni di carristi francesi. In totale, la Wehrmacht ne ha ricevuti 50. Molti di essi sono stati usati come base per la costruzione di obici semoventi e di cannoni anticarro.

Nederlands

Fransse lichte tank uit de Tweede Wereldoorlog

De FCM 36 of Char léger Modèle 1936 FCM was een lichte infanterietank die vlak voor de Tweede Wereldoorlog werd ontwikkeld voor het Franse leger. Hij werd gebouwd door Forges et Chantiers de la Méditerranée (FCM) en was een moderne Fransse lichte infanterietank. Met een bemanning van twee personen was het uitgerust met een 37 mm kort kanon en een 7,5 mm coaxiaal machinegeweer. Hij werd aangedreven door een dieselmotor, maar het ontwerp en de technologie waren inferieur aan die van sommige Duitse tanks uit die tijd.

De FCM 36 nam deel aan de Frans-Duitse gevechten van mei/juni 1940.

Na de nederlaag van Frankrijk in de zomer van 1940 vielen veel Fransse pantservoertuigen in handen van de Wehrmacht. Ze werden vervolgens gebruikt in verschillende gevechtsoperaties, maar ook als ondersteunings- en trainingsuitrusting.

Onder de buitgemaakte voertuigen bevonden zich FCM 36 tanks, die eerder hadden toebehoord aan twee Fransse tankbataljons. In totaal ontving de Wehrmacht er 50. Veel ervan werden later gebruikt als basis voor de bouw van zelfrijdende houwitseren en antitankkanonnen.

1/35

FCM 36

30322

PEINTURES ESSENTIELLES / ESSENTIAL PAINTS



11

Argent métallique
Silver Metallic
Silber metallisch



30

Vert foncé mat
Dark Green Matt
Dunkelgrün matt



33

Noir mat
Black Matt
Schwarz matt



34

Blanc mat
White Matt
Weiß matt



53

Gris métallique
Gunmetal Metallic
Grau metallisch



56

Aluminium métallique
Aluminium Metallic
Aluminium metallisch



62

Cuir mat
Leather Matt
Leder matt



65

Bleu avion mat
Aircraft Blue Matt
Flugzeugblau matt



90

Vert beige mat
Beige Green Matt
Beigegrün matt



92

Gris fer mat
Iron Grey Matt
Eisengrau matt



103

Crème mat
Cream Matt
Creme matt



110

Bois naturel mat
Natural Wood Matt
Naturholz matt



113

Rouille mat
Rust Matt
Rost matt



186

Brun mat
Brown Matt
Braun matt



a FCM 36, 4ème Bataillon de Chars de Combat, 2ème Compagnie, Mai 1940
FCM 36, 4th Combat Tank Battalion, 2nd Company, May 1940

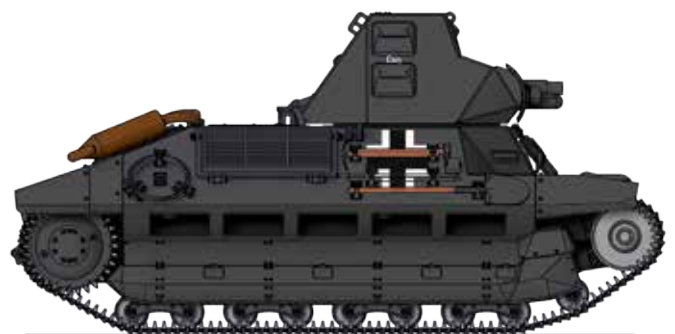

b Panzerkampfwagen 737 FCM (f), fin 1940
Panzerkampfwagen 737 FCM (f), by the end of 1940

2

Numéro de phase
Step number
Schrittnummer
Número de fase

56

Référence de couleur
Colour reference no
Farbangabe
Referencia de color

37

Numéro de pièce
Part number
Teilenummer
Número de pieza

6

Numéro de decal
Decal number
Abziehbildnummer
Número de calcomanía

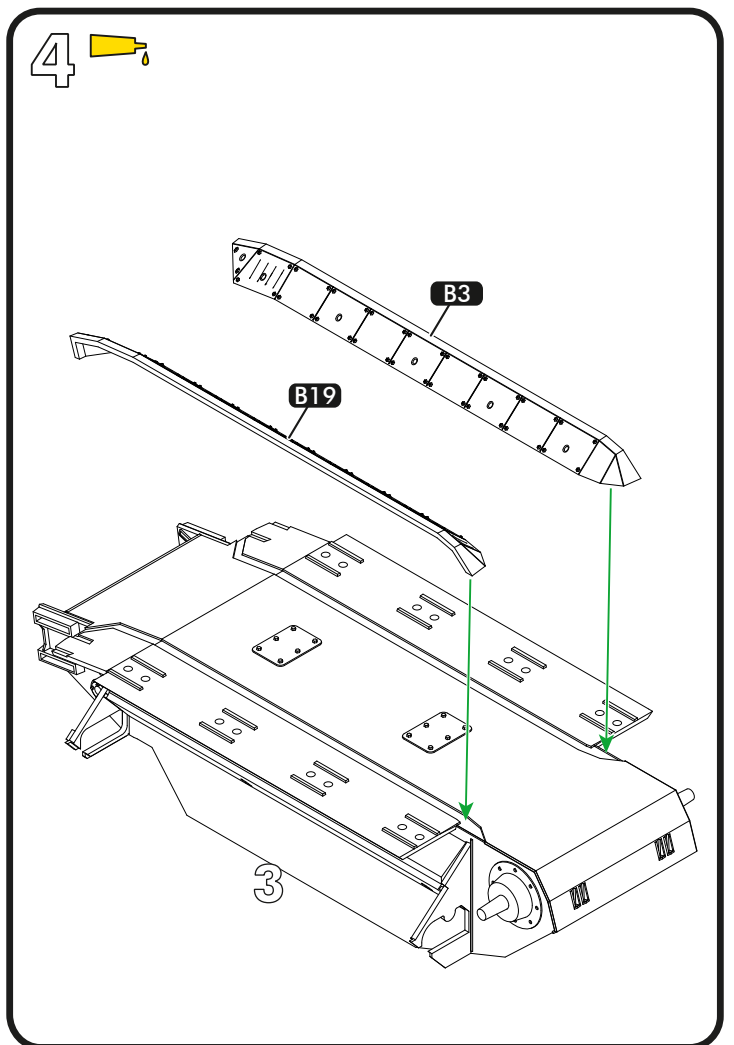
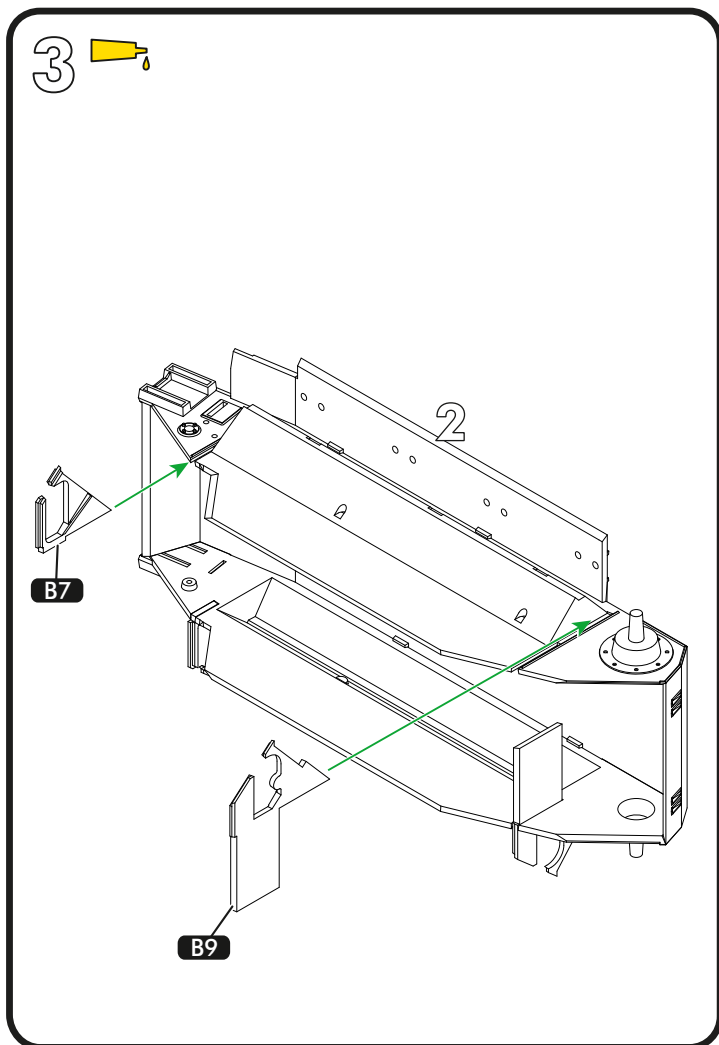
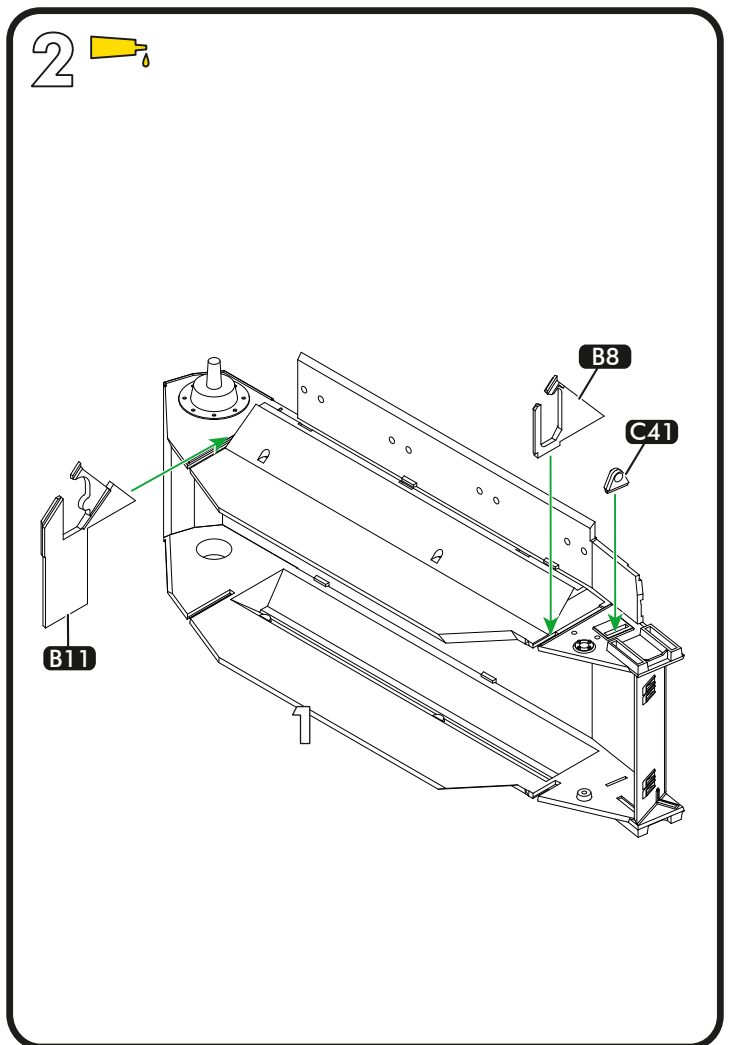
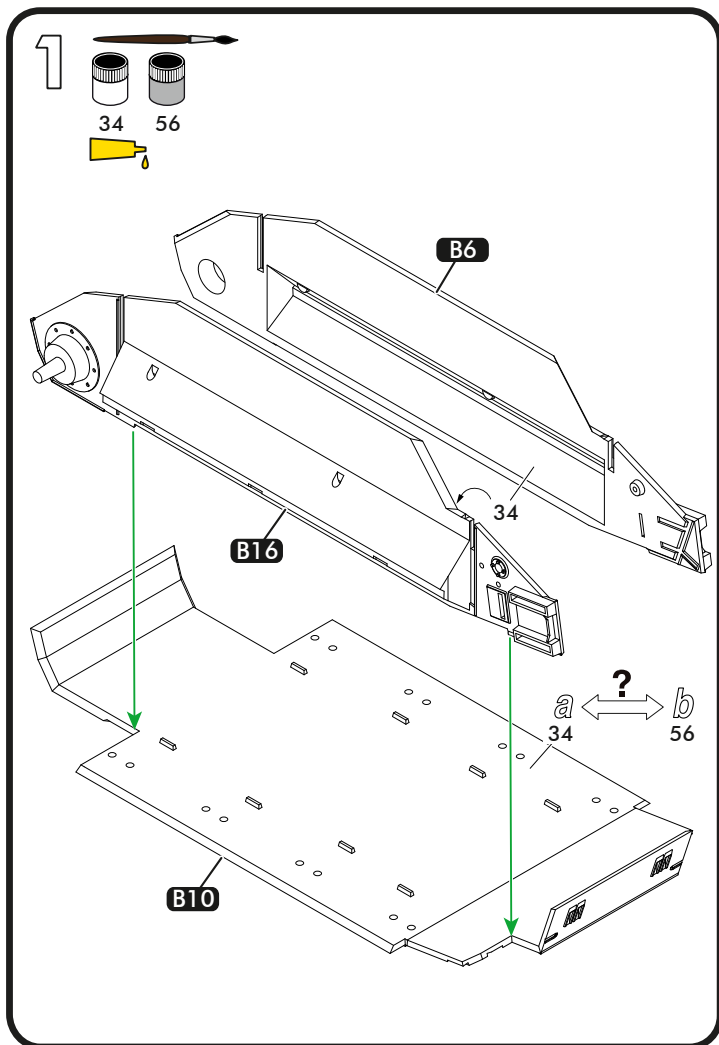

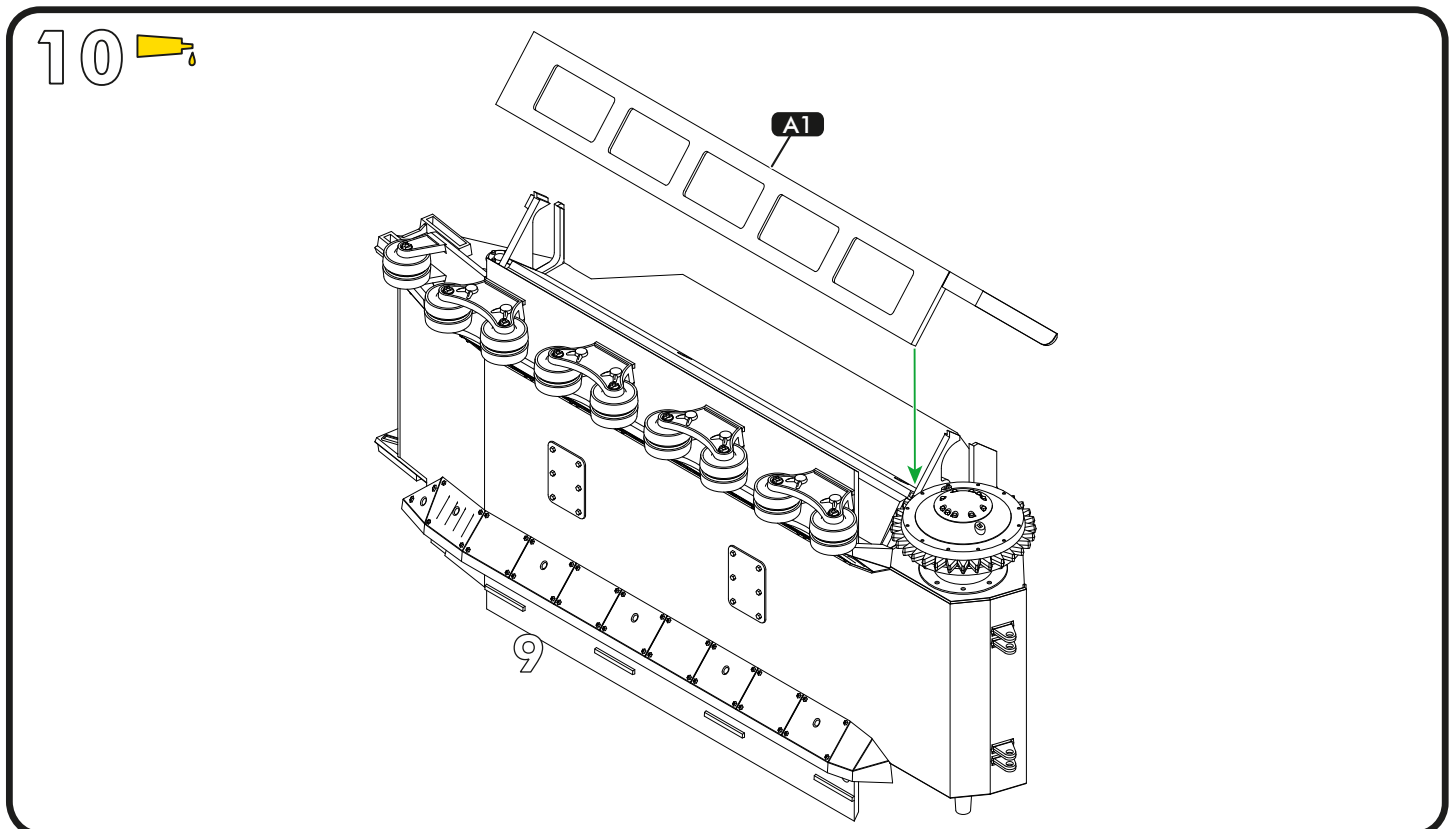
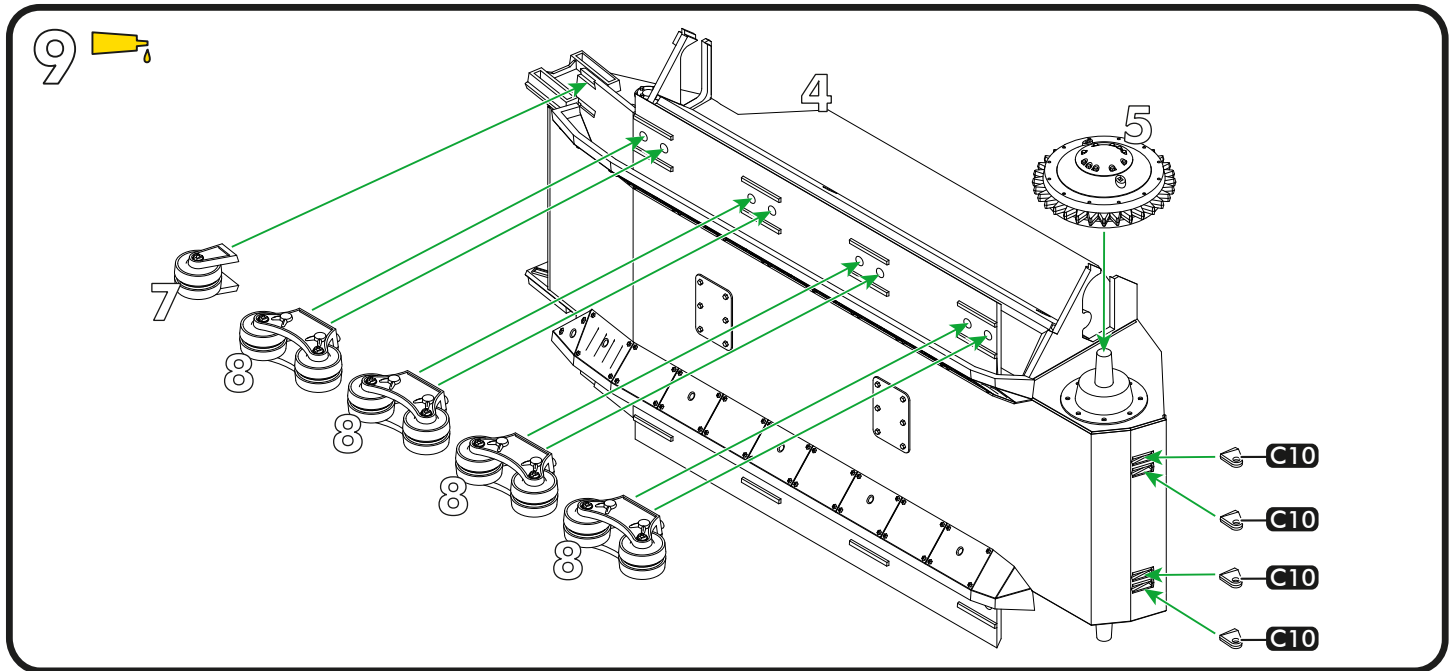
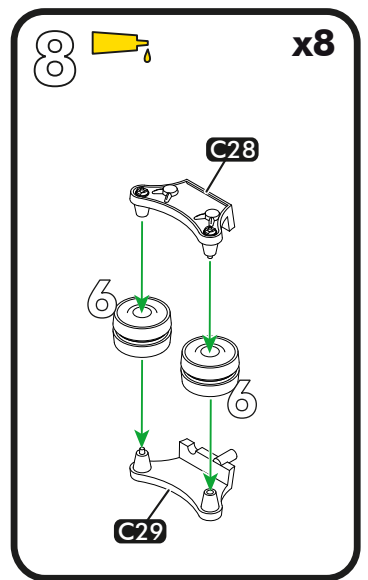
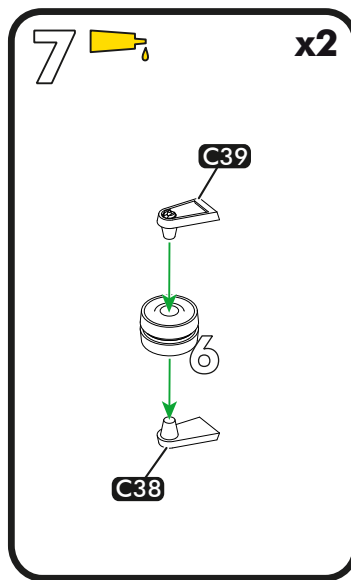
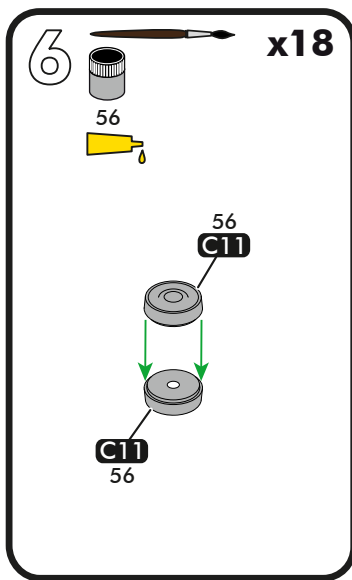
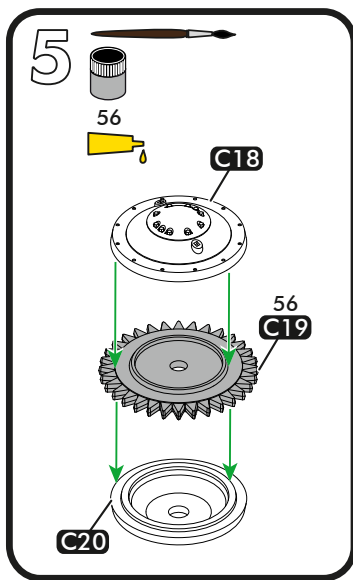

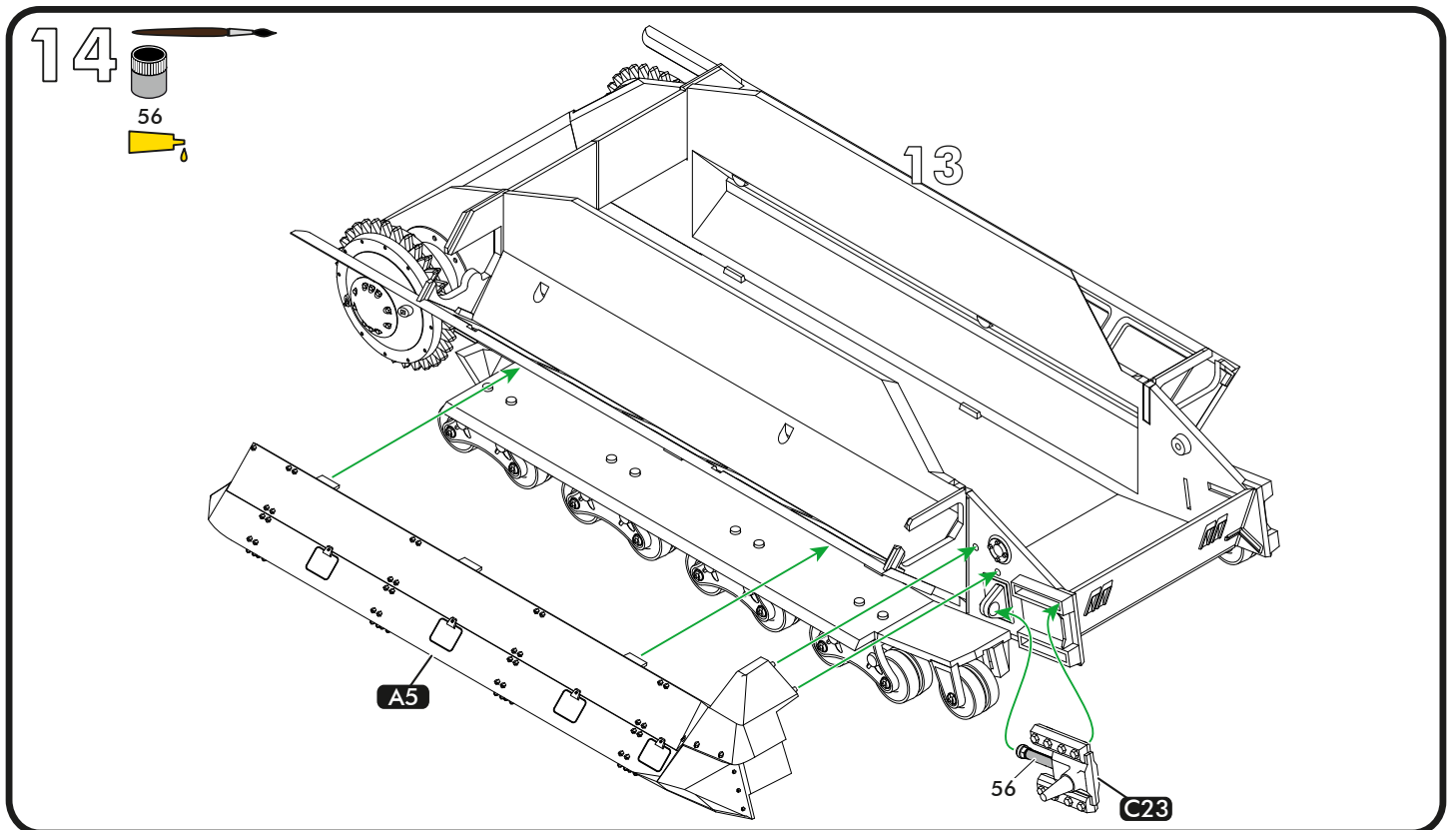
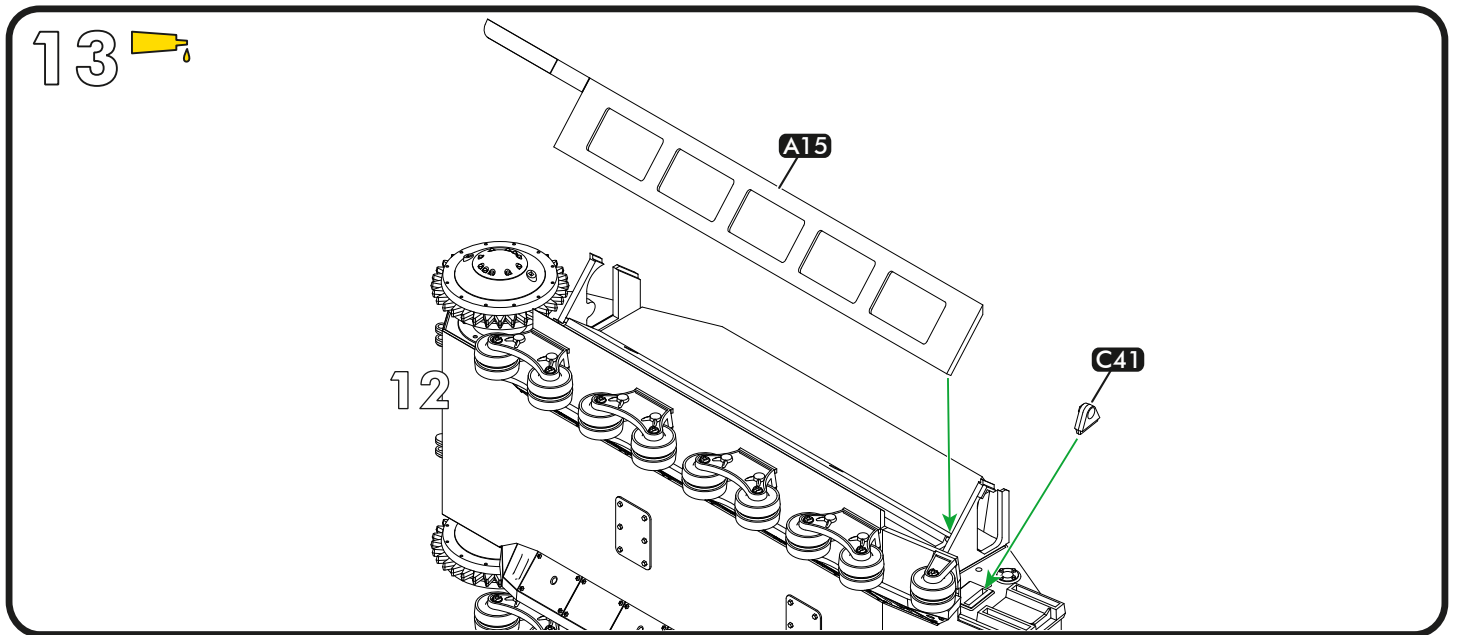
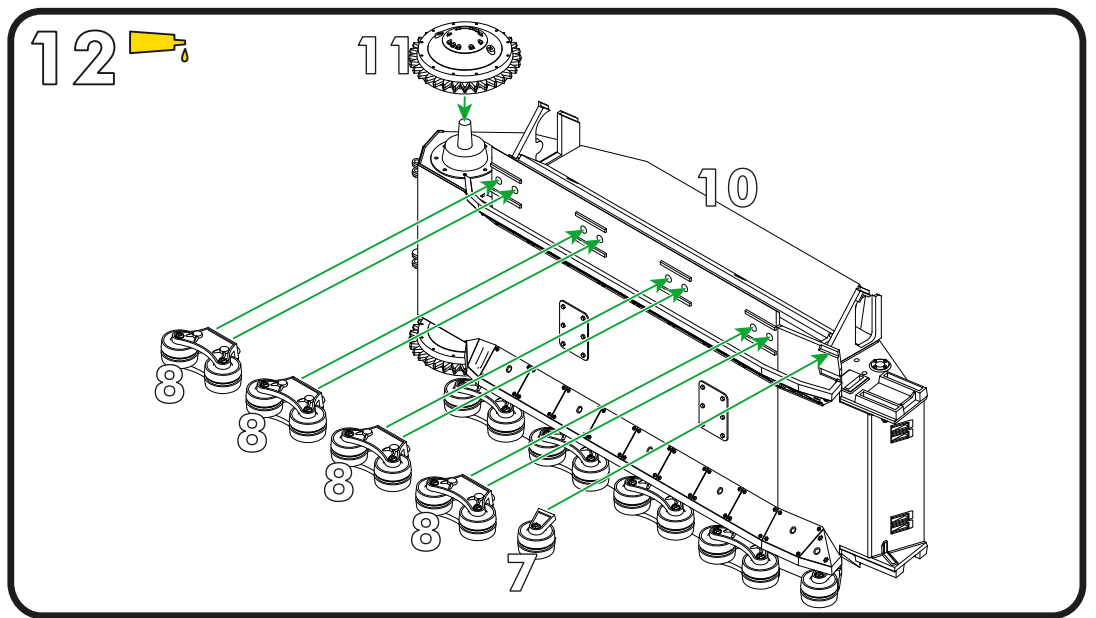
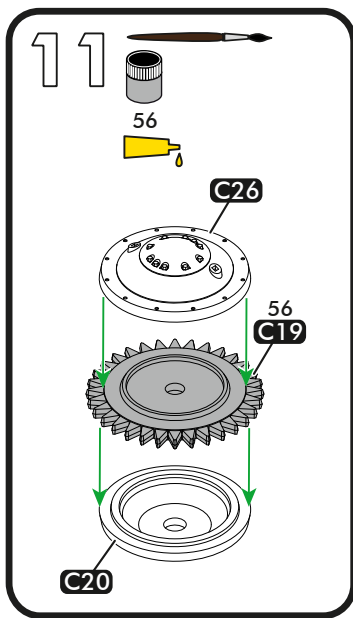

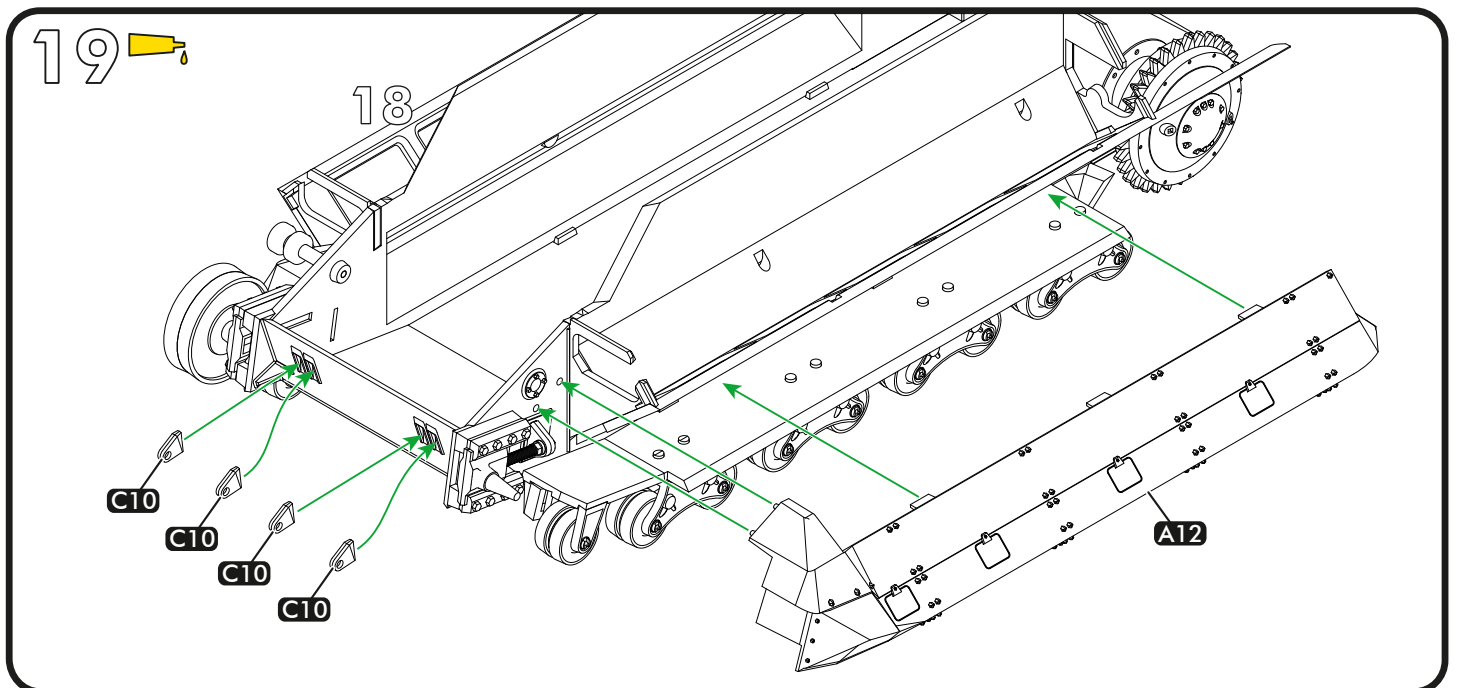
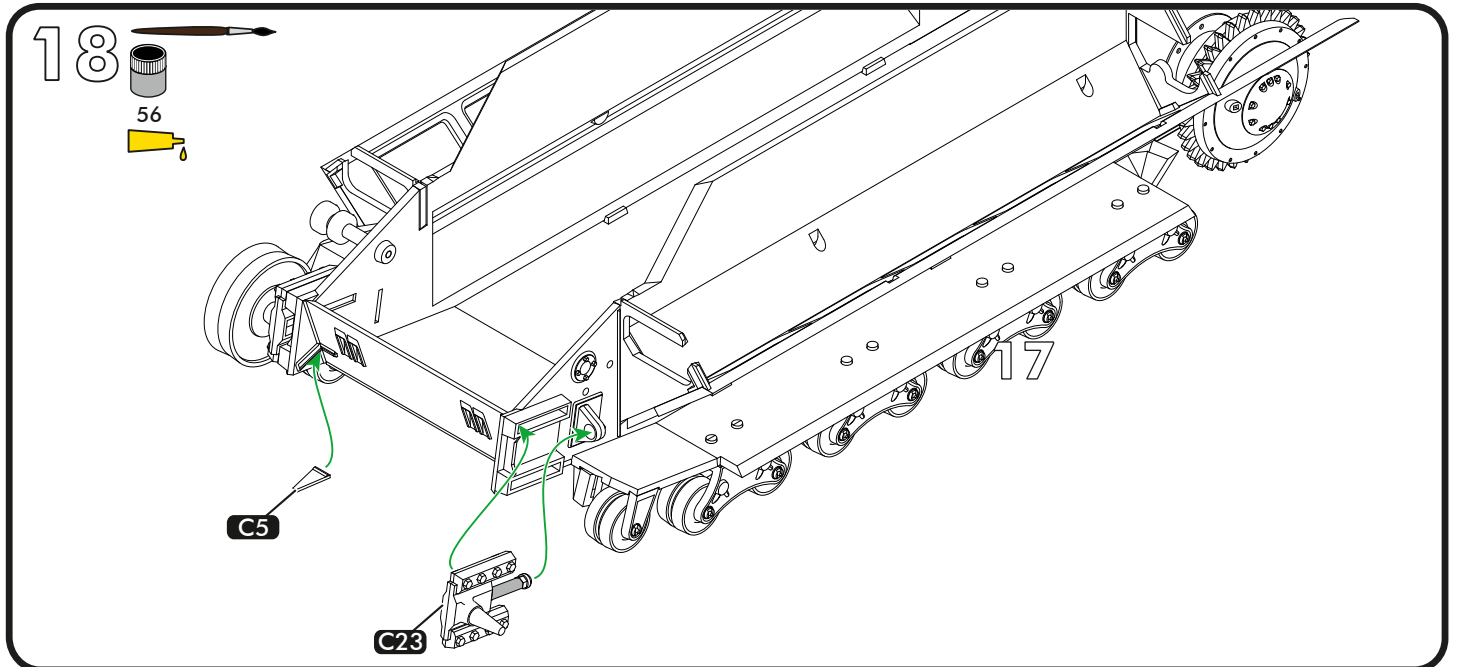
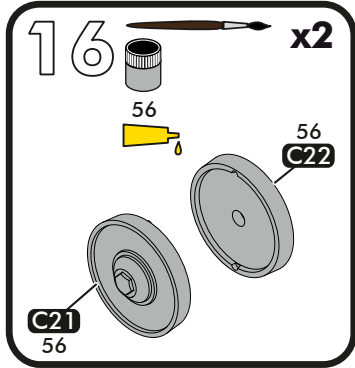
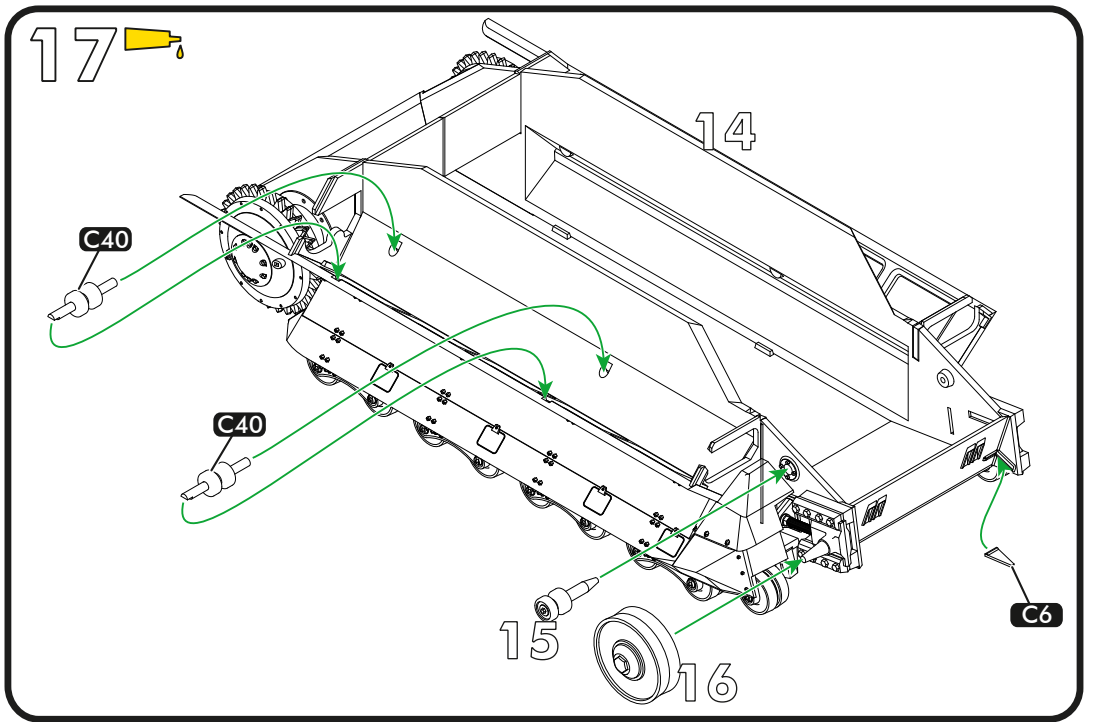
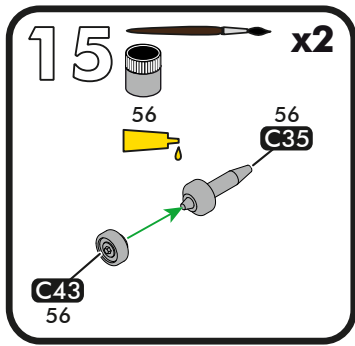

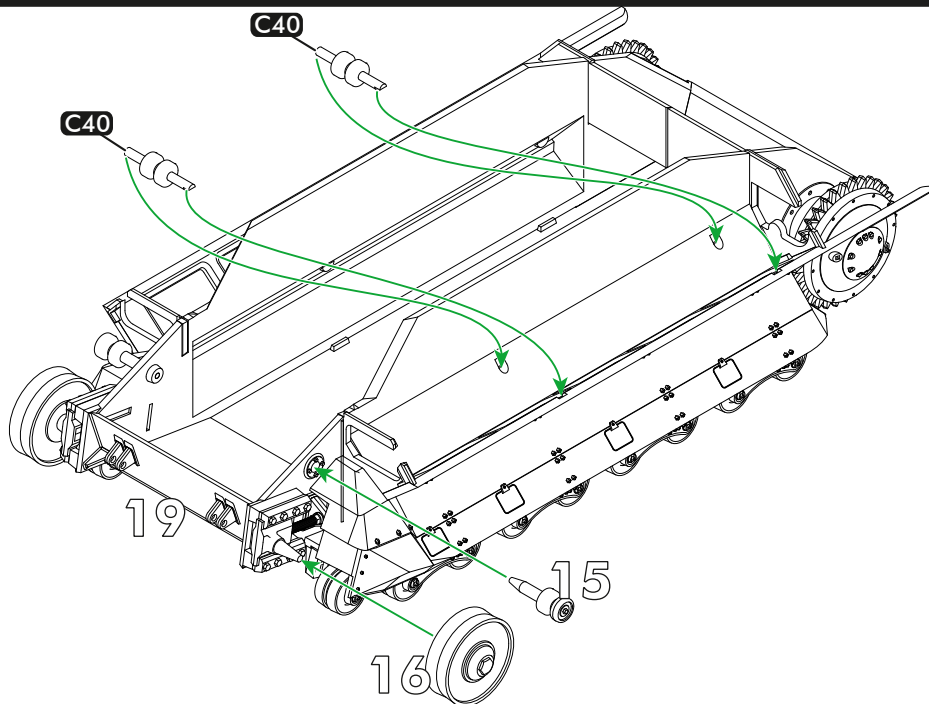

20 

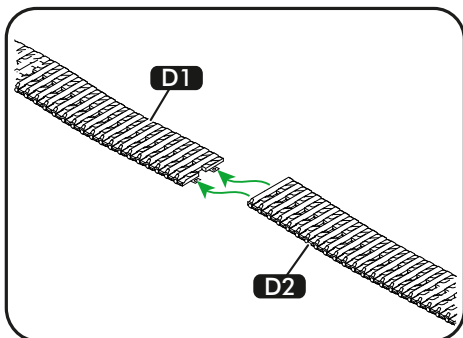
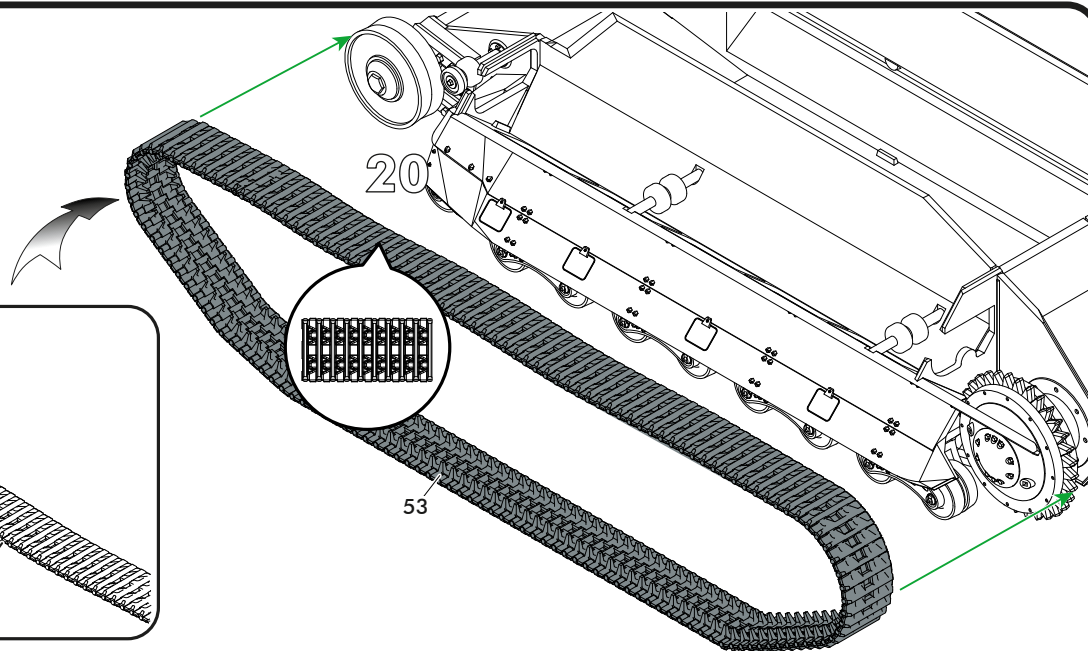

21 



22 

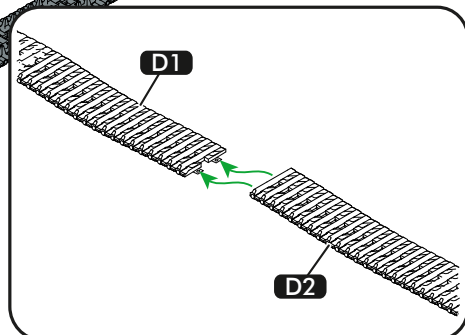
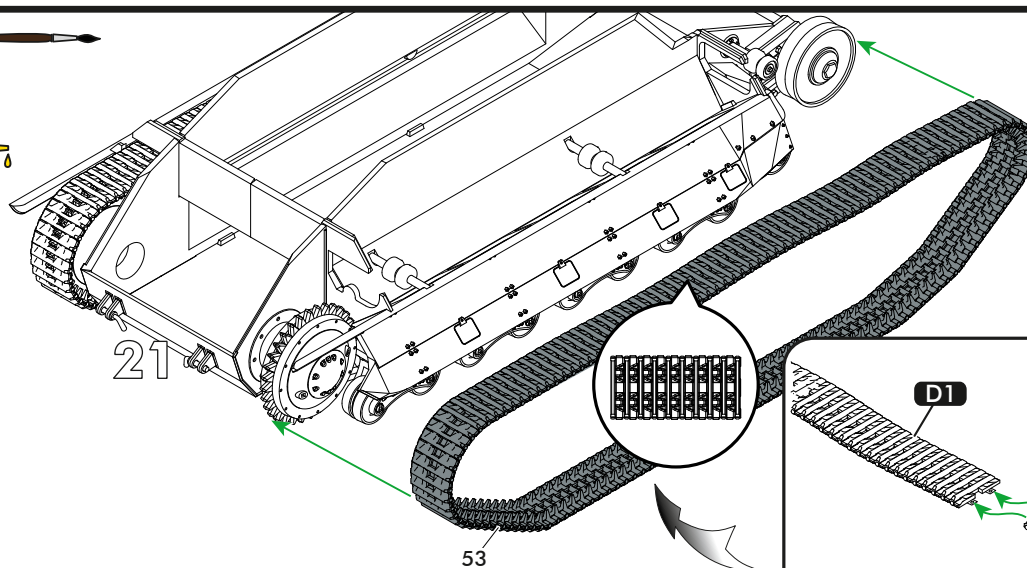

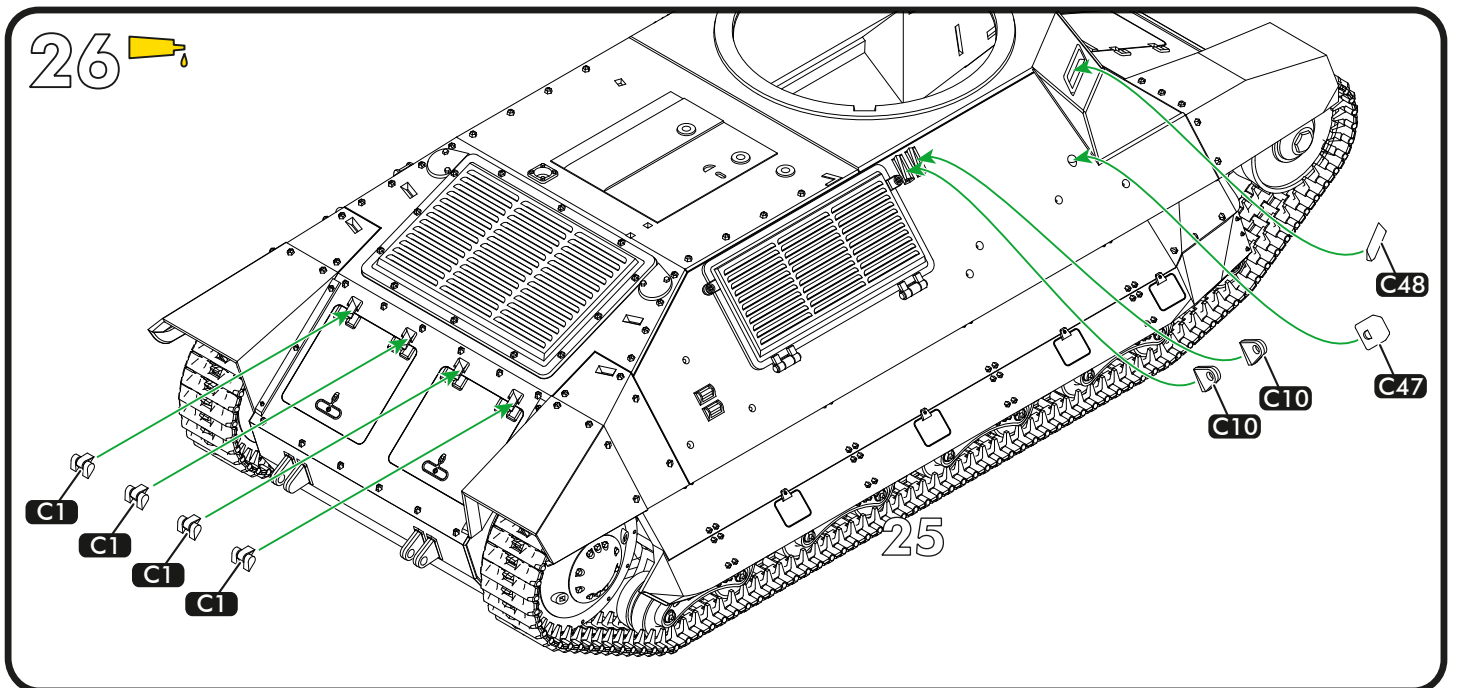
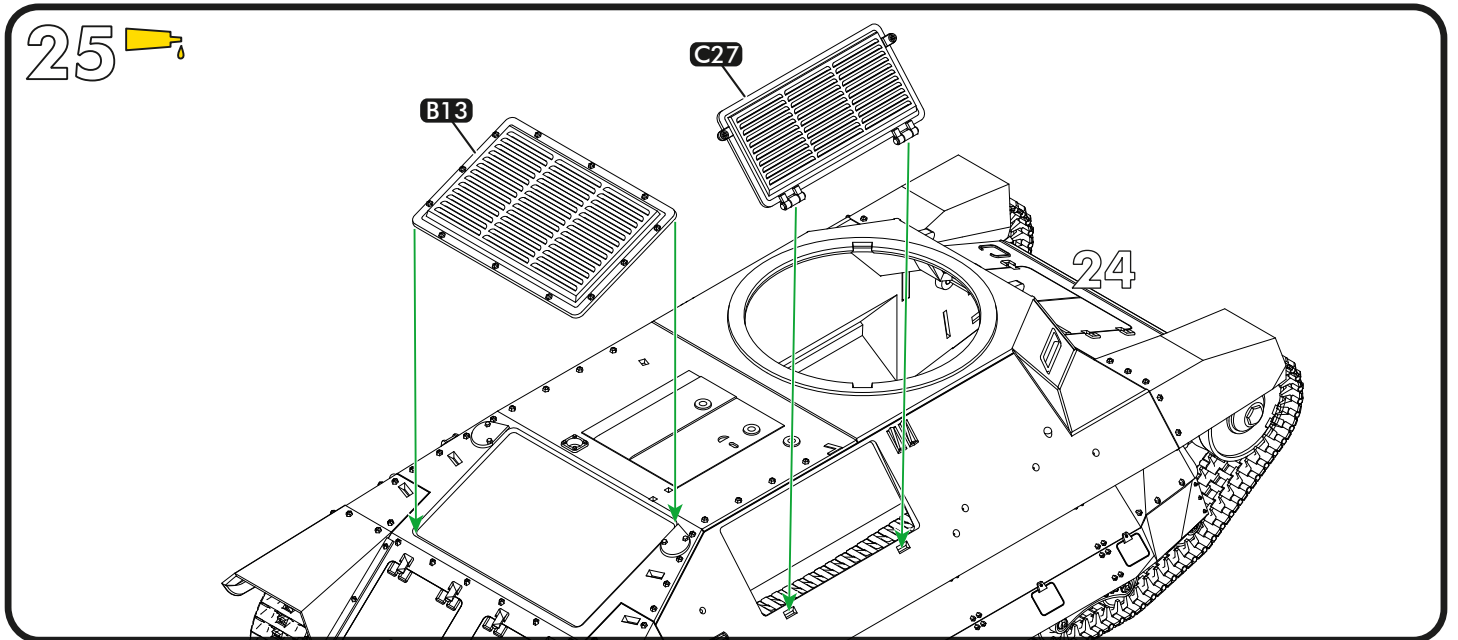
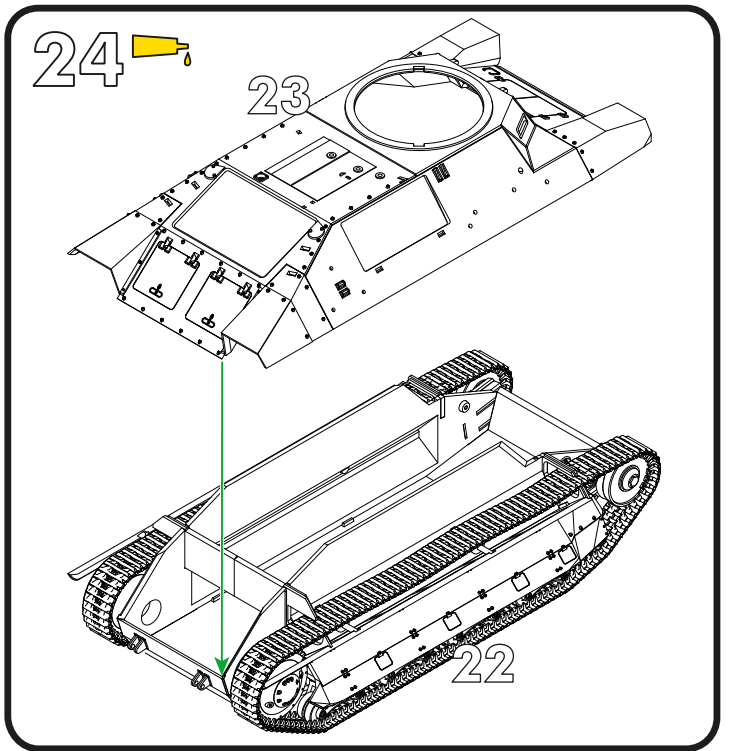
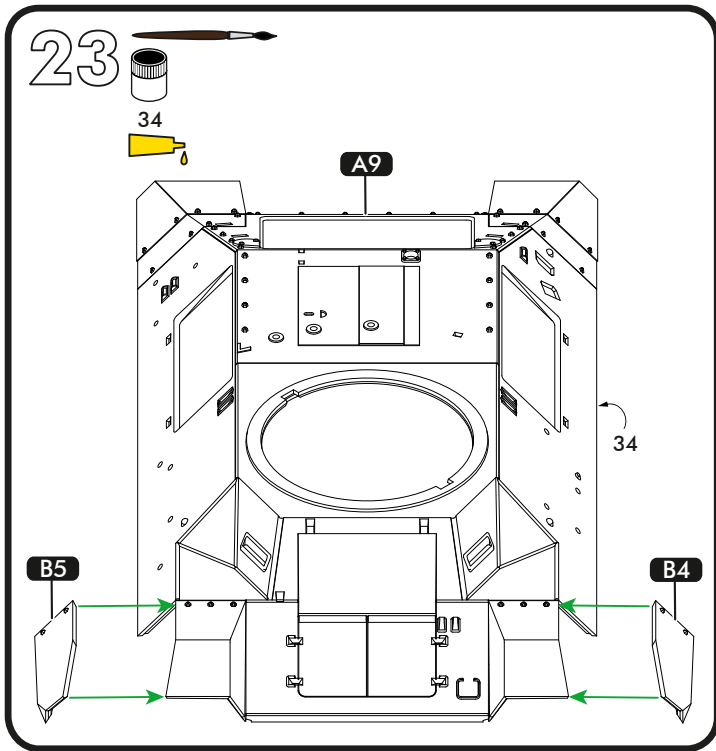

27

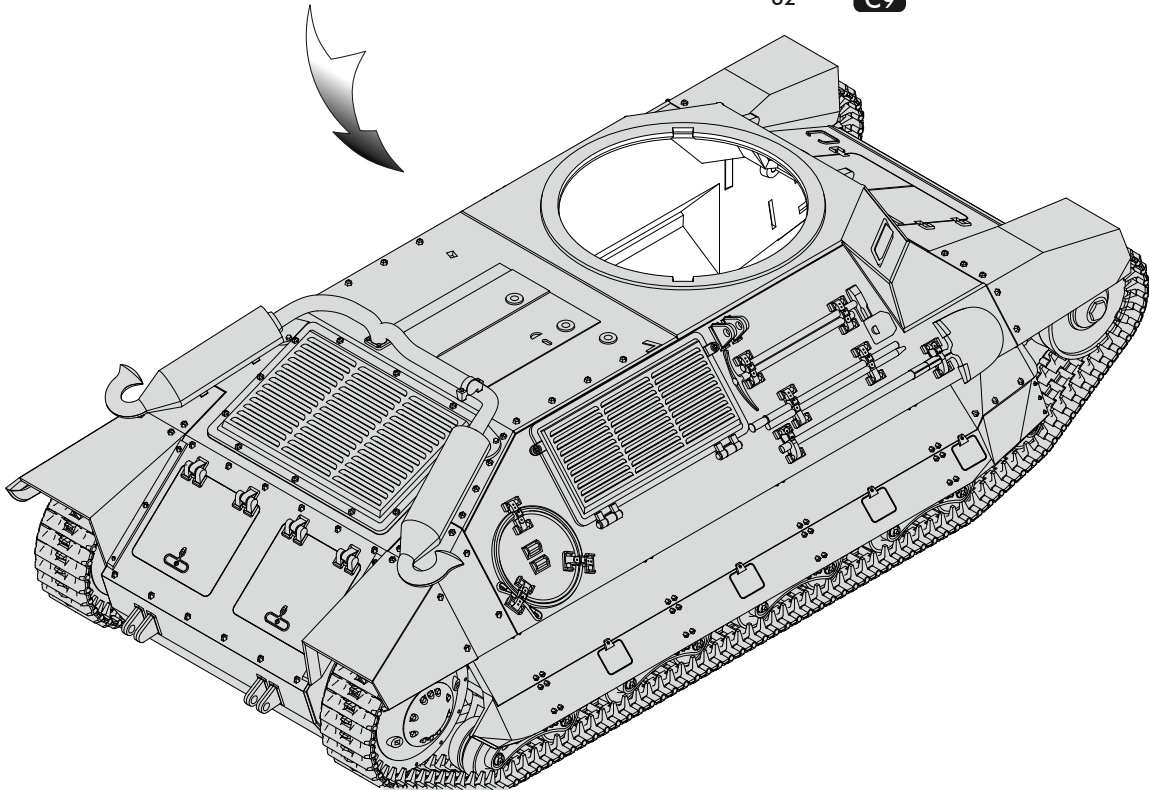
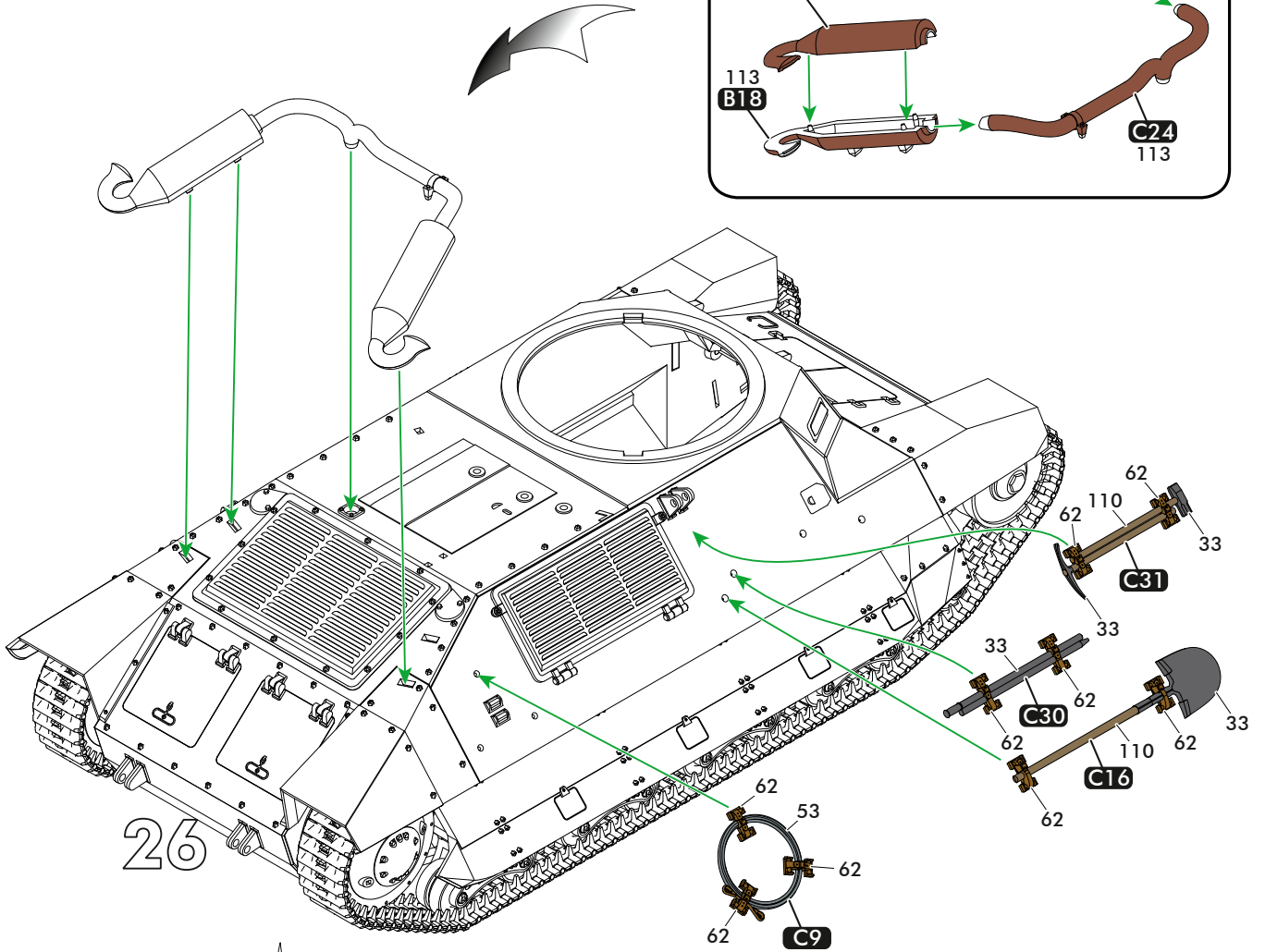
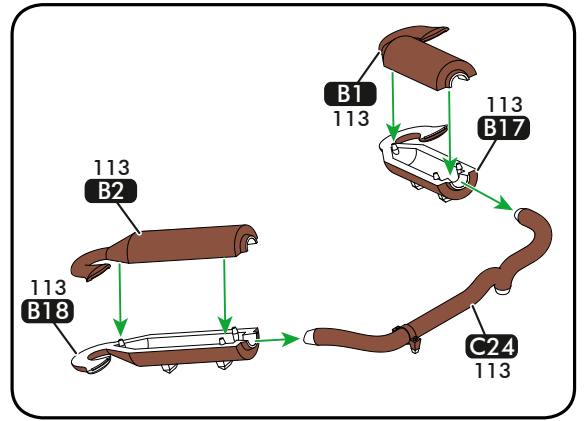
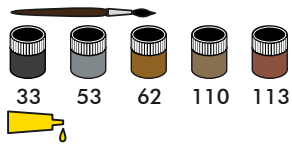

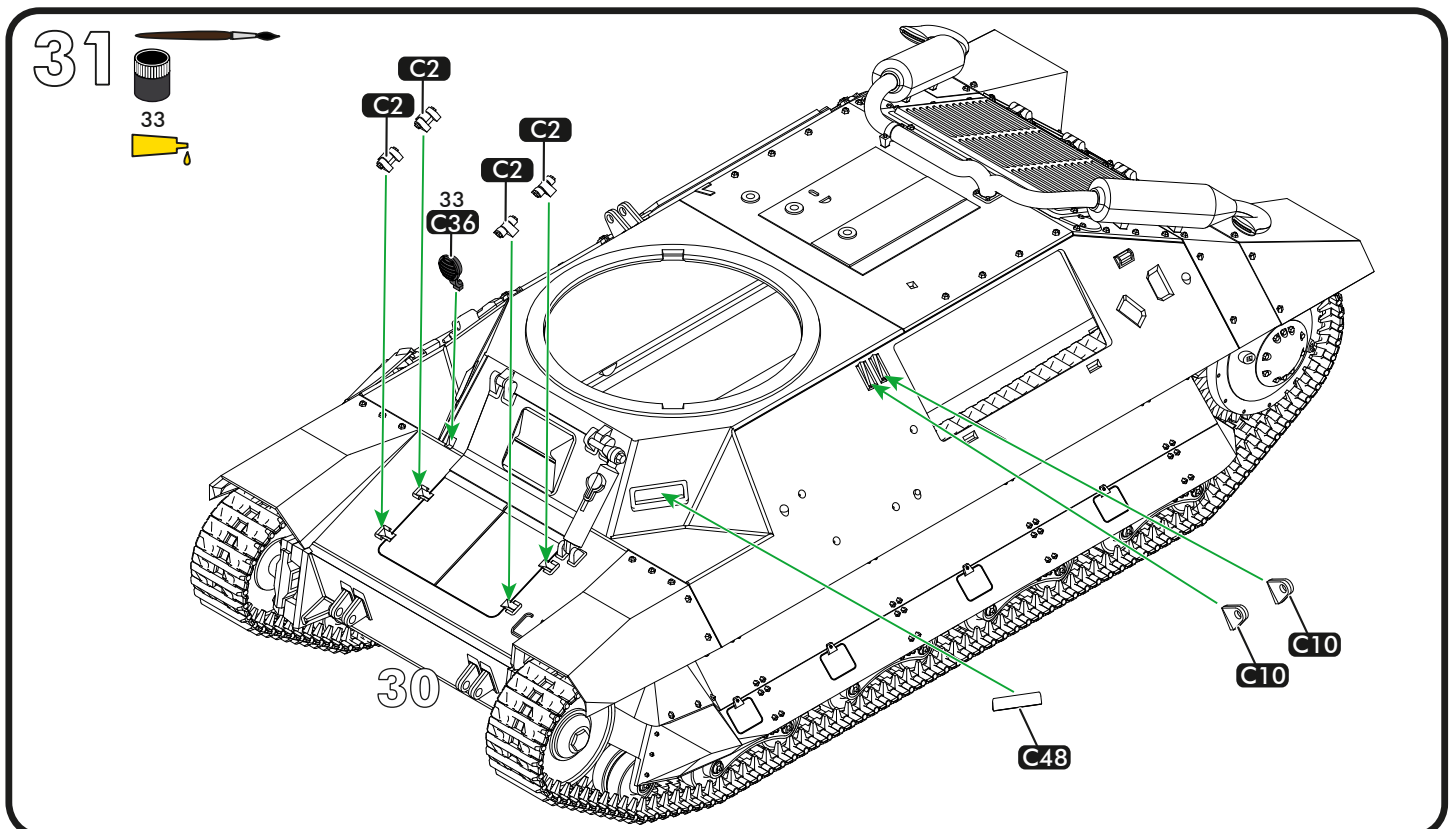
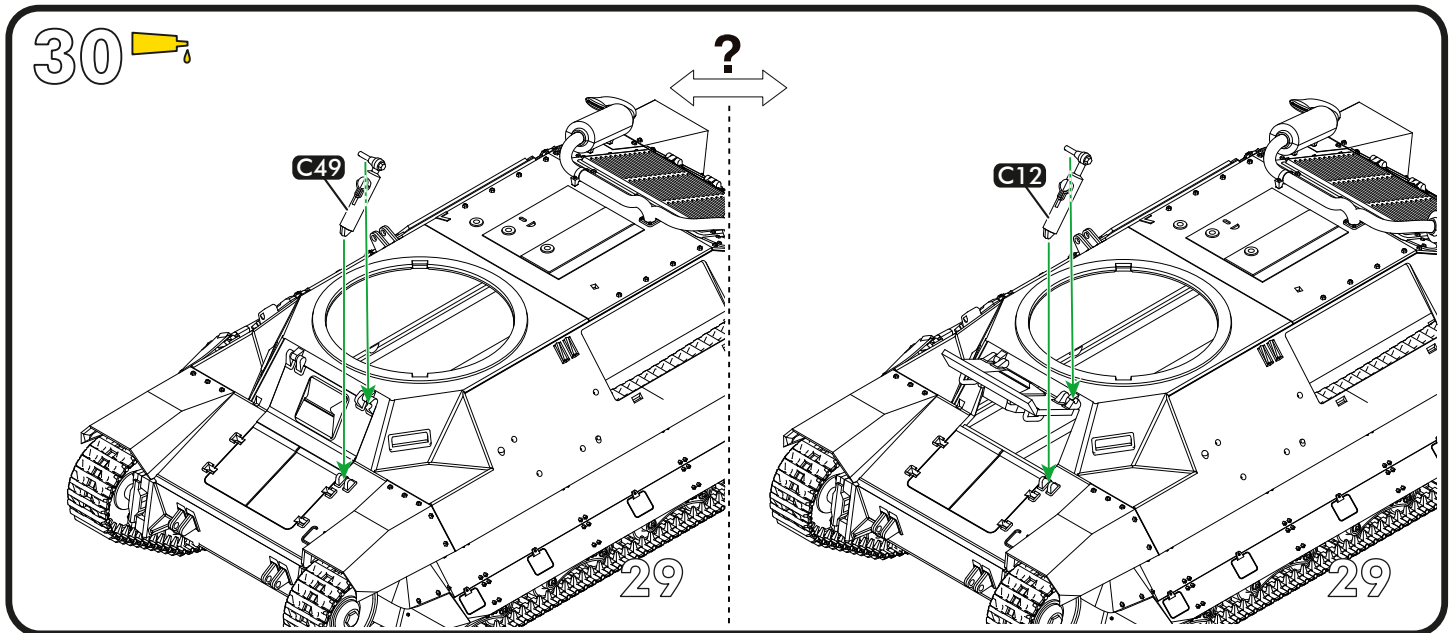
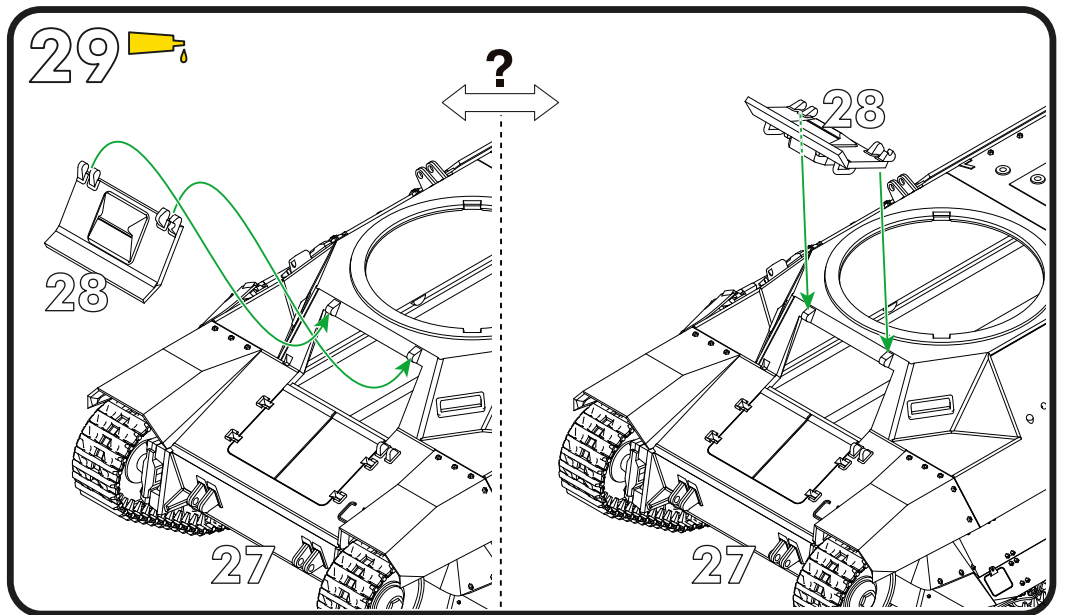
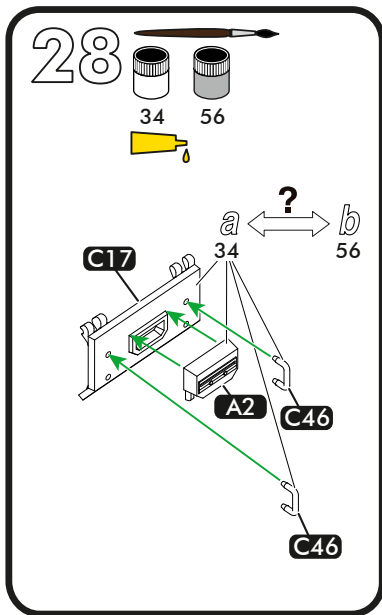

32

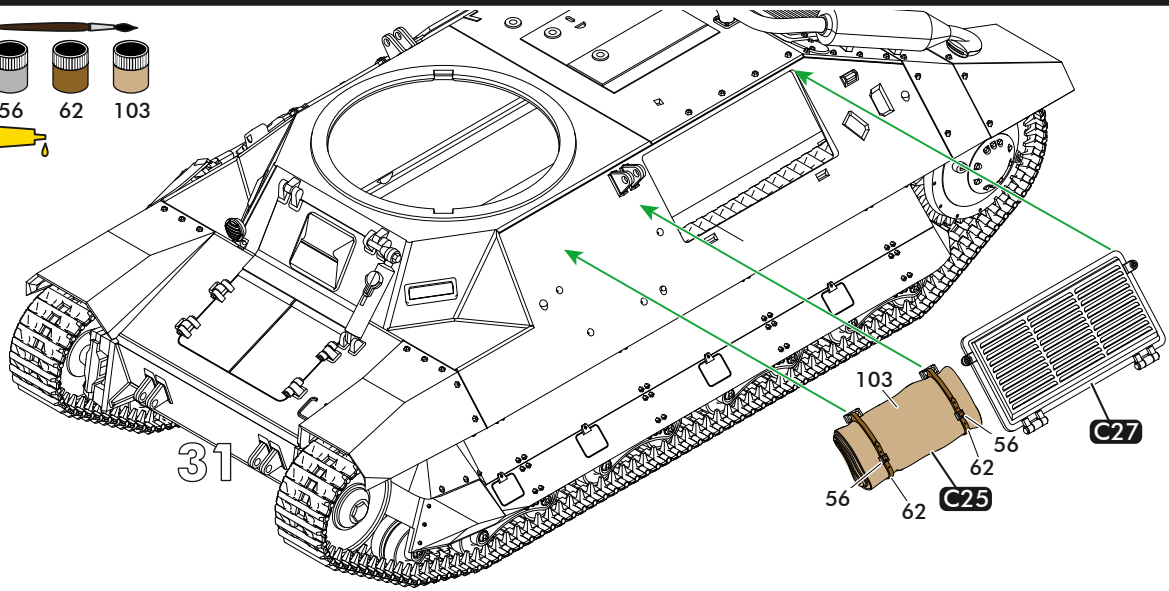
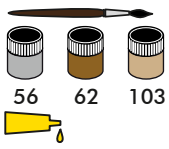

33

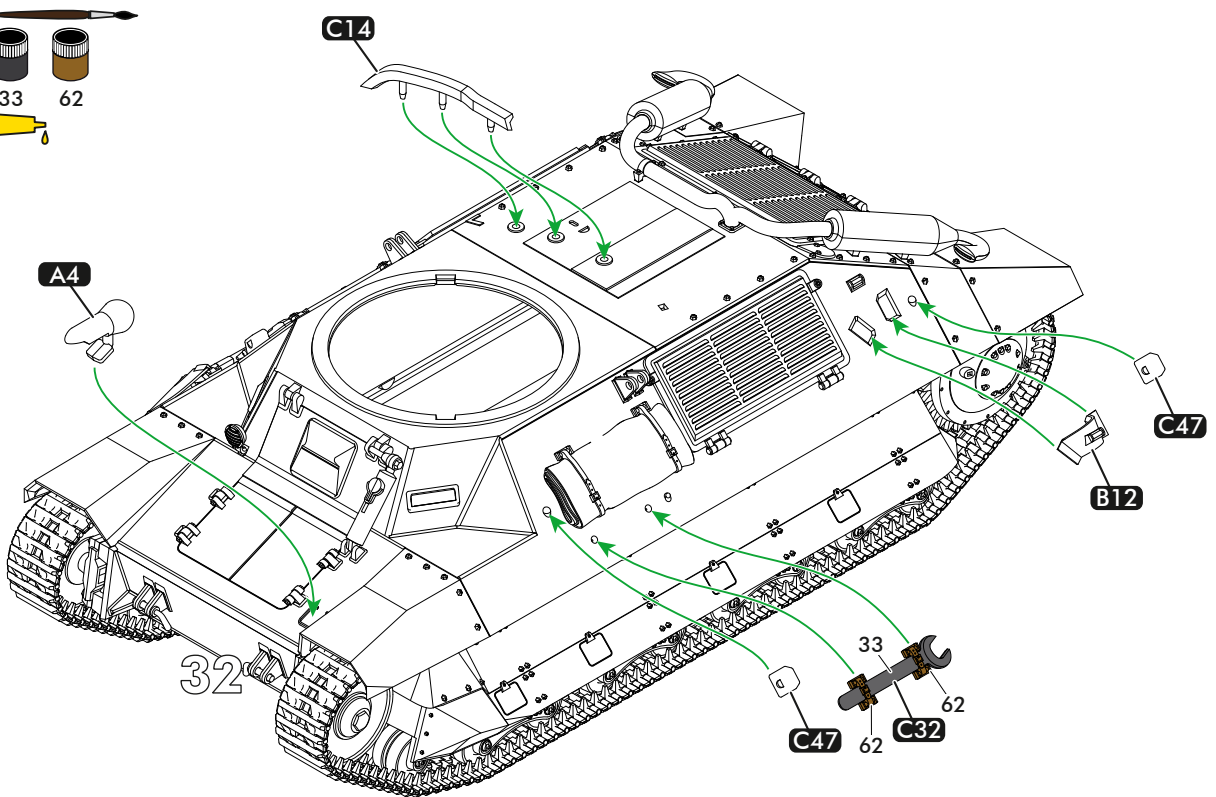
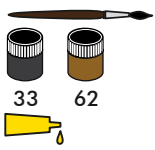

34

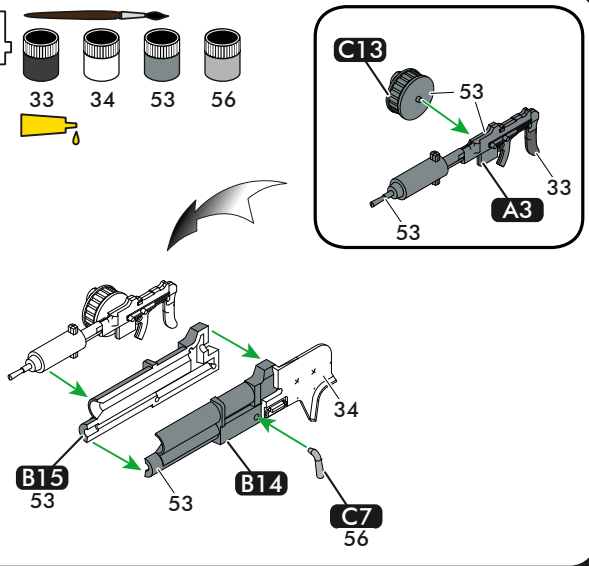
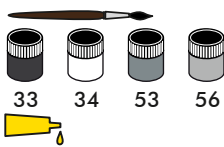

35

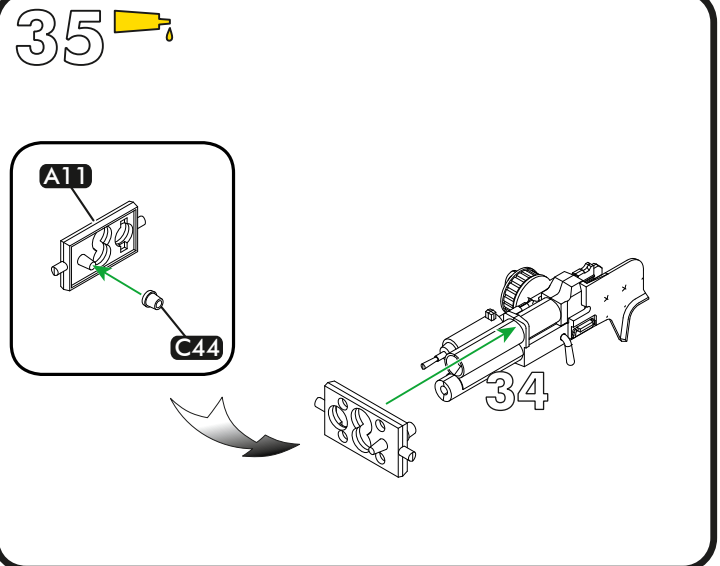

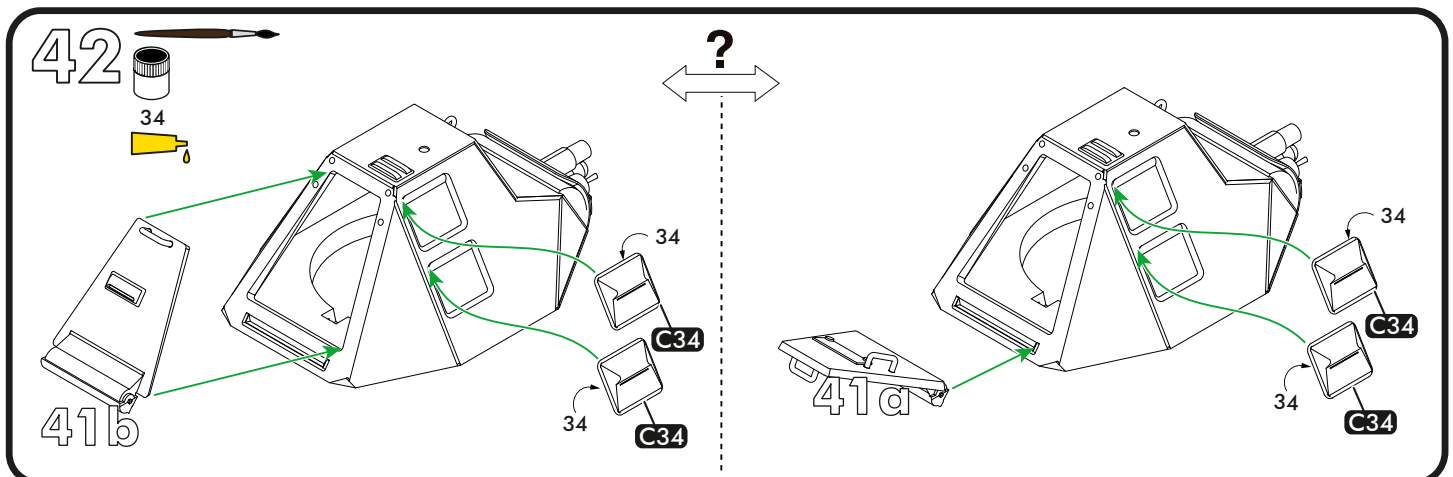
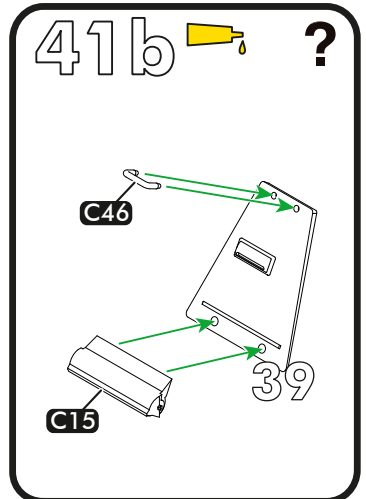
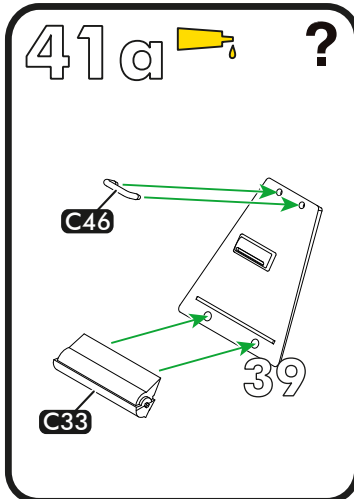
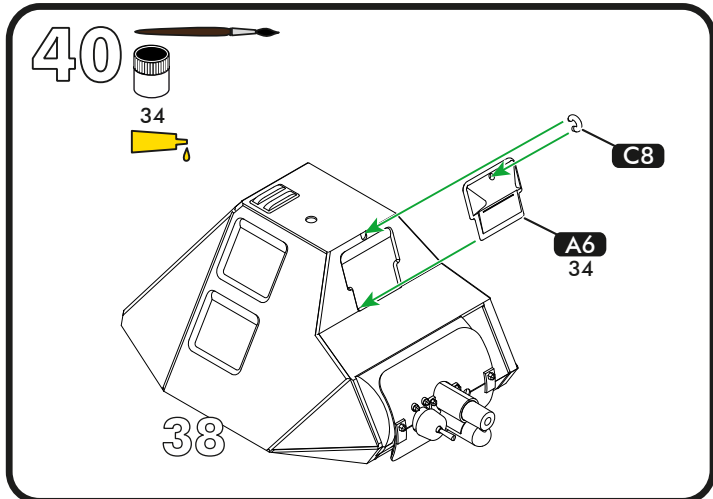
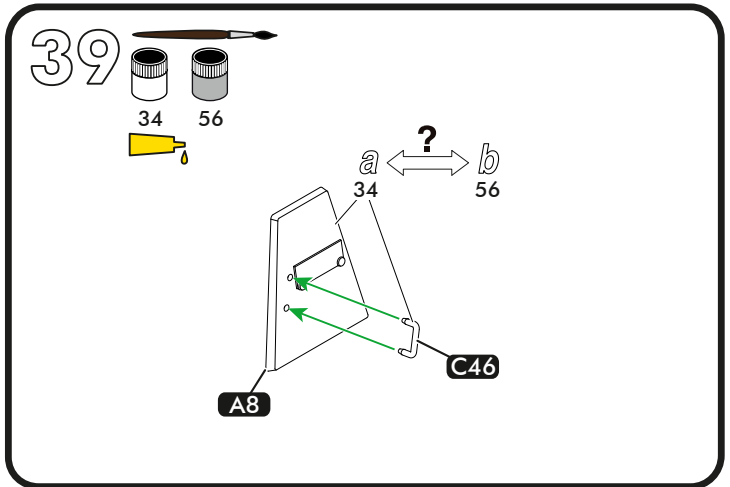
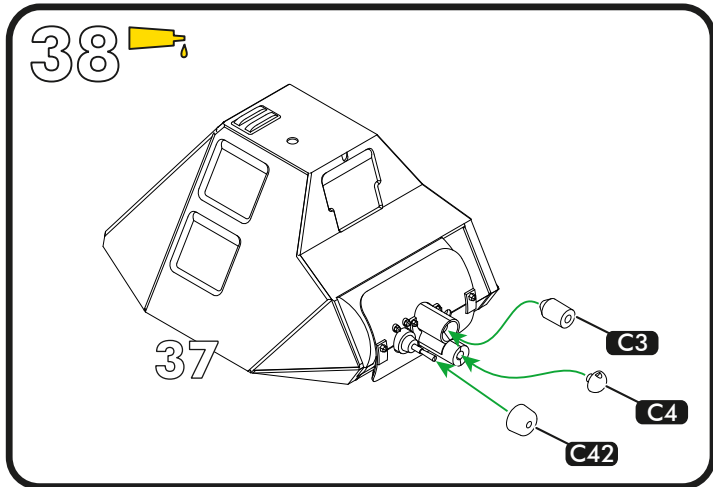
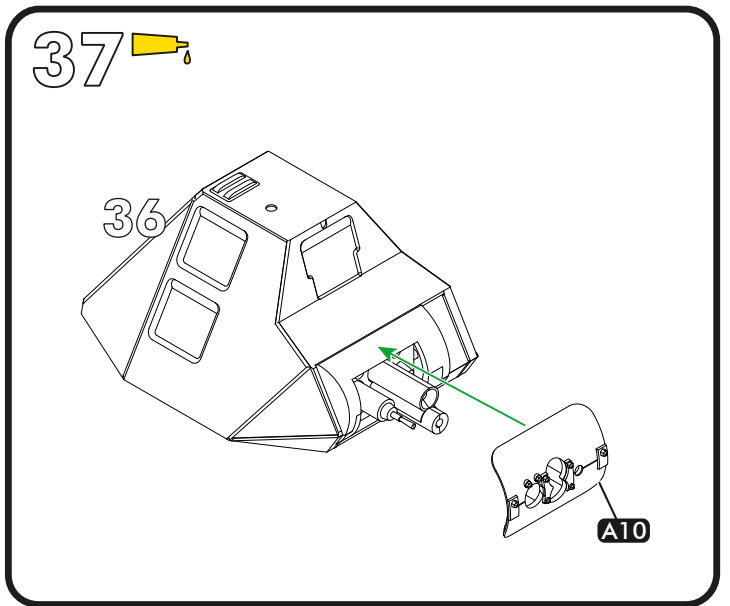
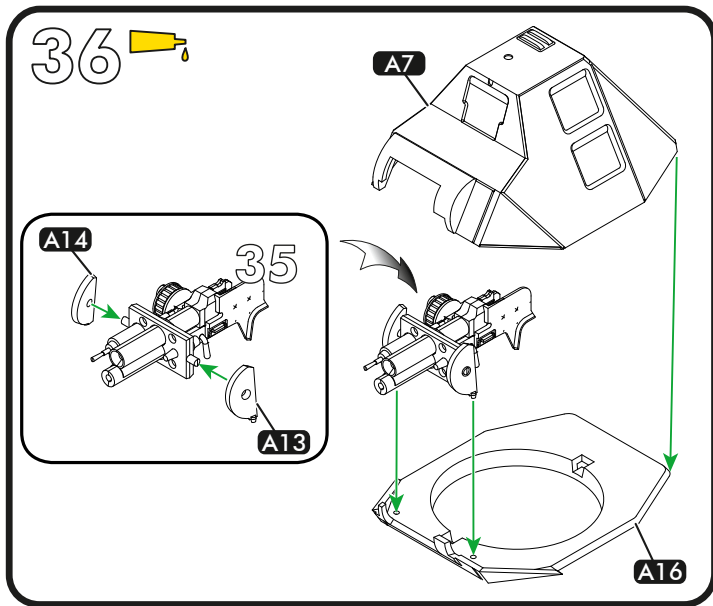

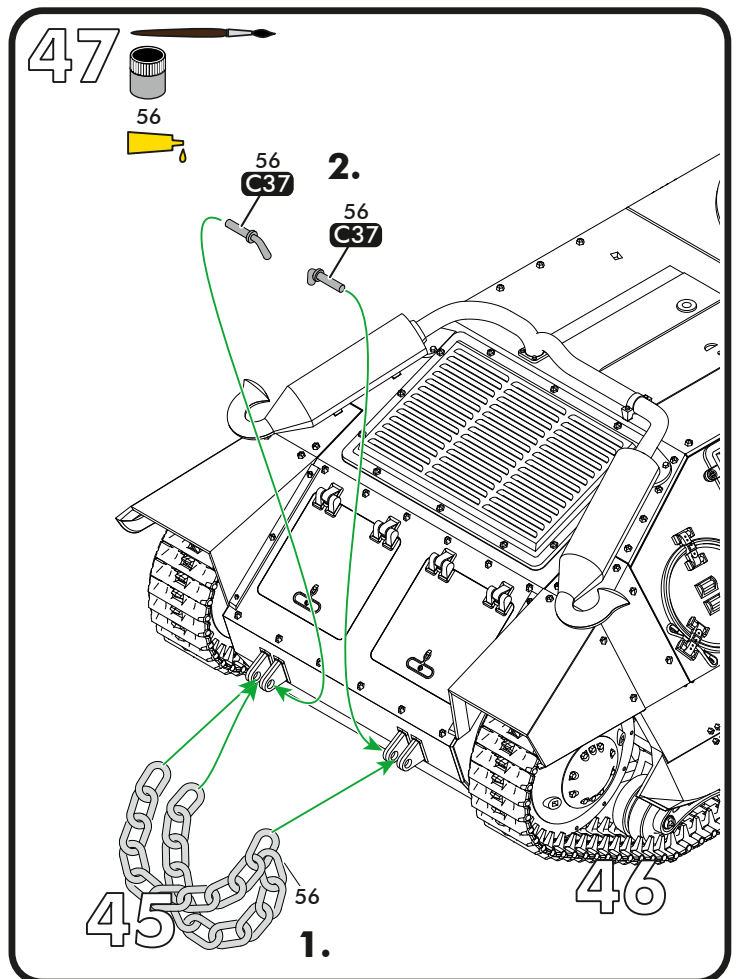
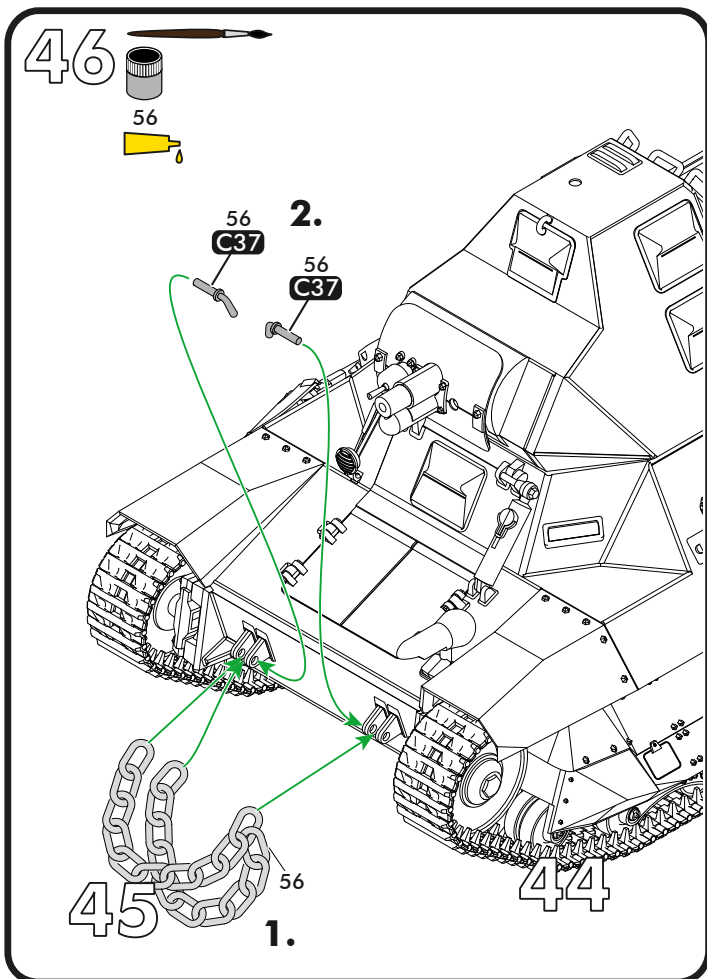
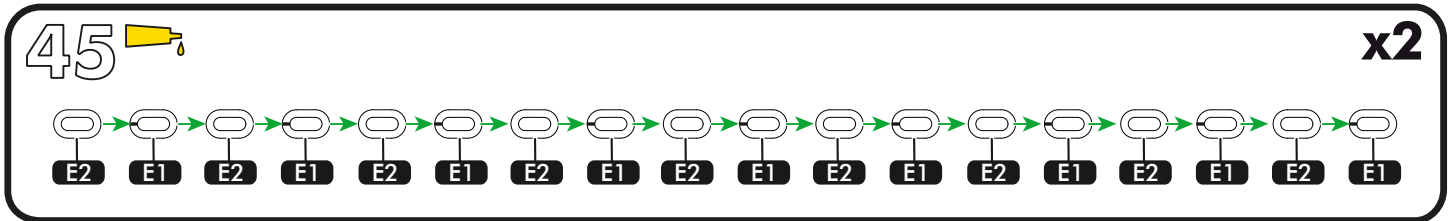
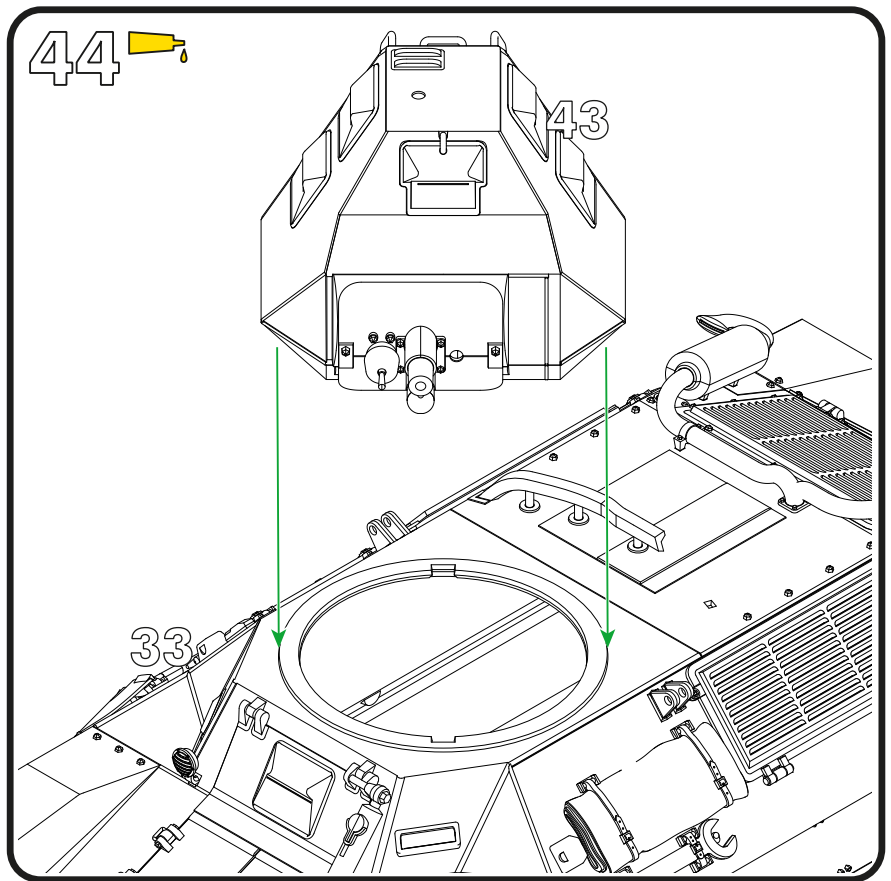
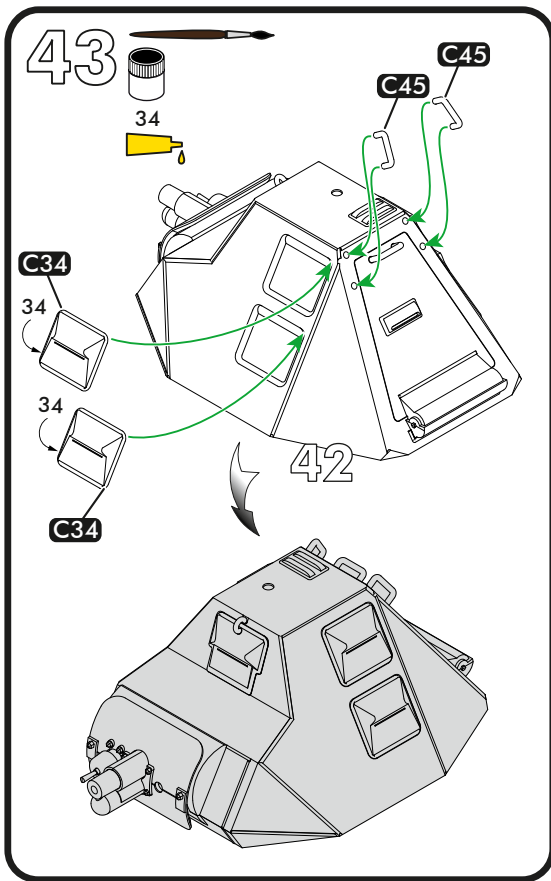

48

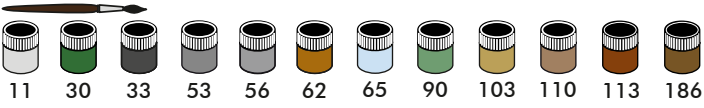

a FCM 36, 4ème Bataillon de Chars de Combat, 2ème Compagnie, Mai 1940
 FCM 36, 4th Combat Tank Battalion, 2nd Company, May 1940

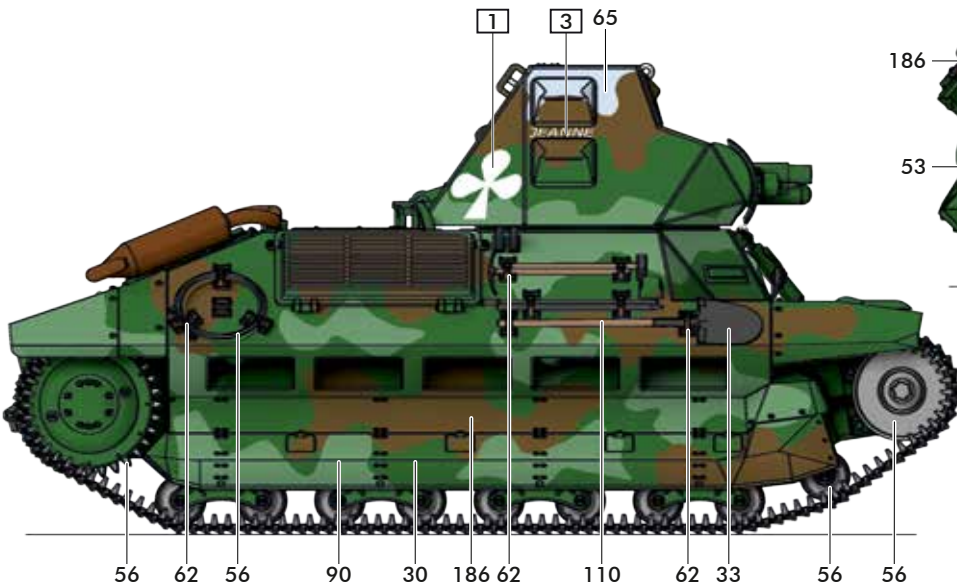
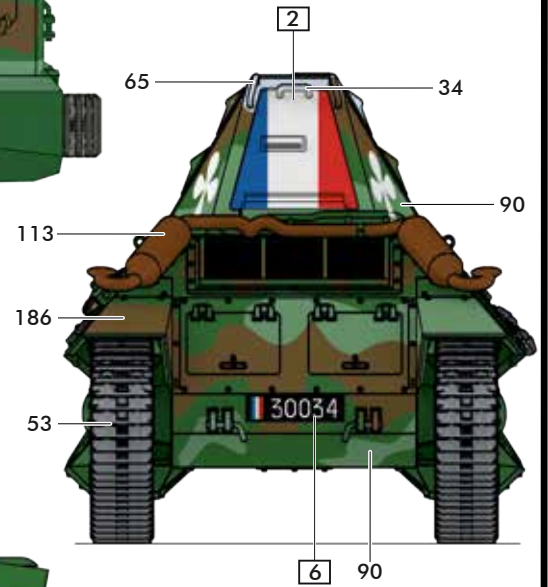
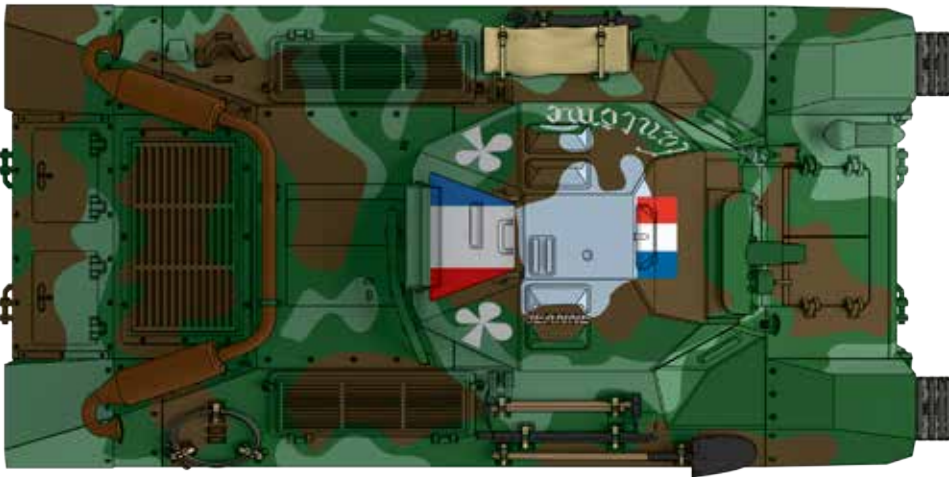
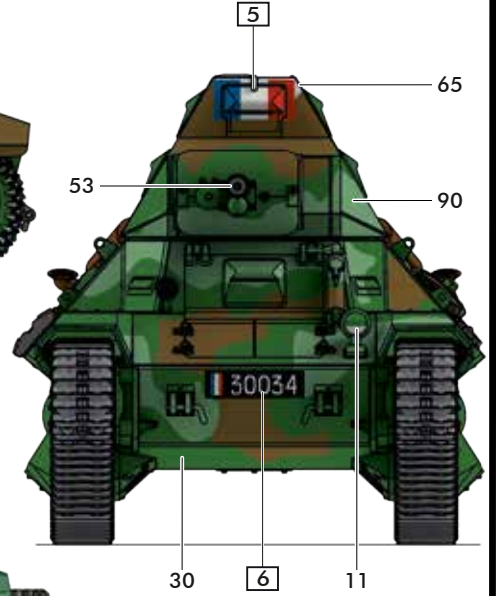
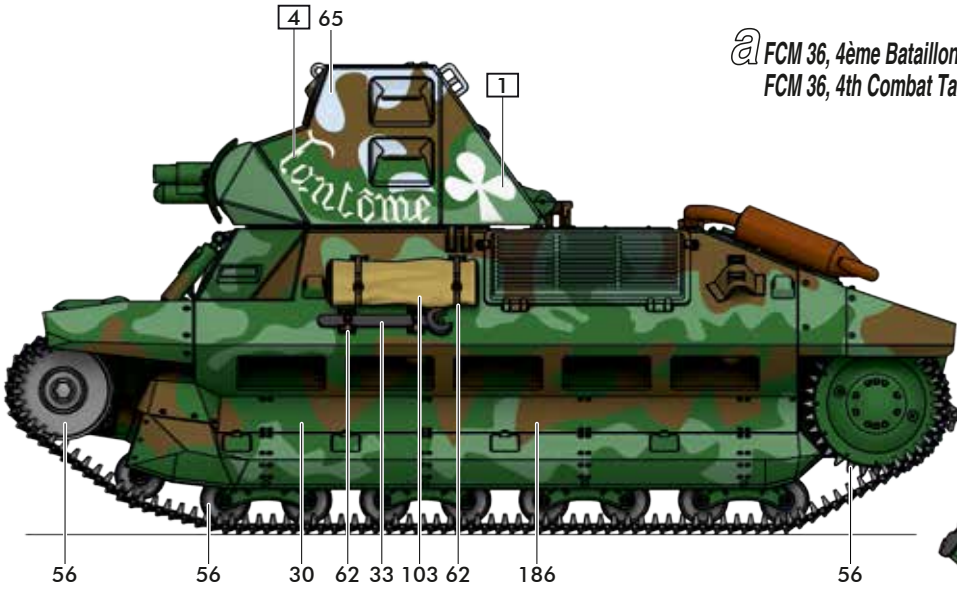

48

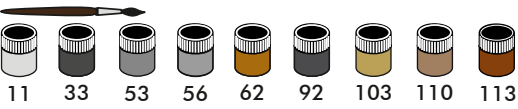

b Panzerkampfwagen 737 FCM (f), fin 1940
 Panzerkampfwagen 737 FCM (f), by the end of 1940

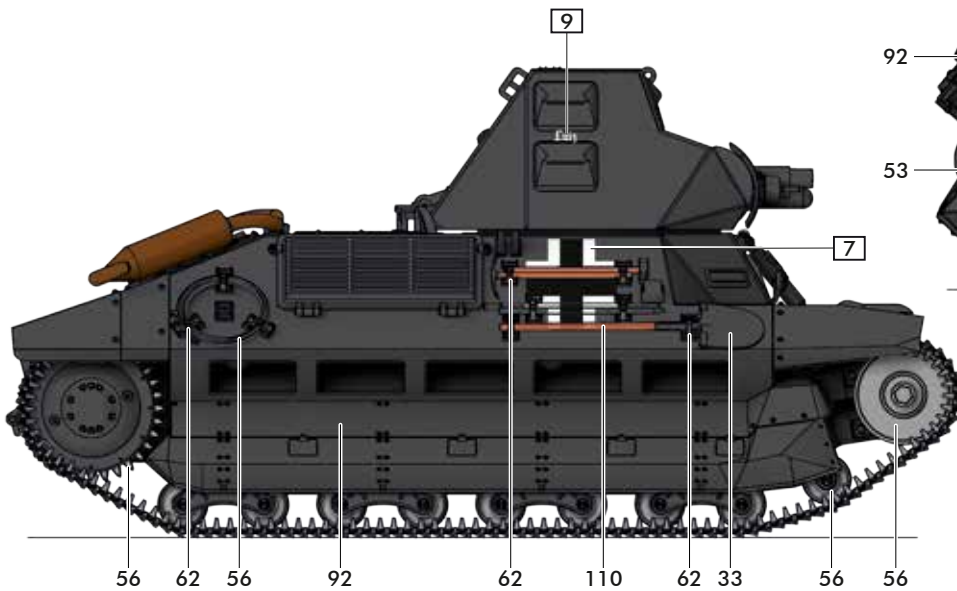
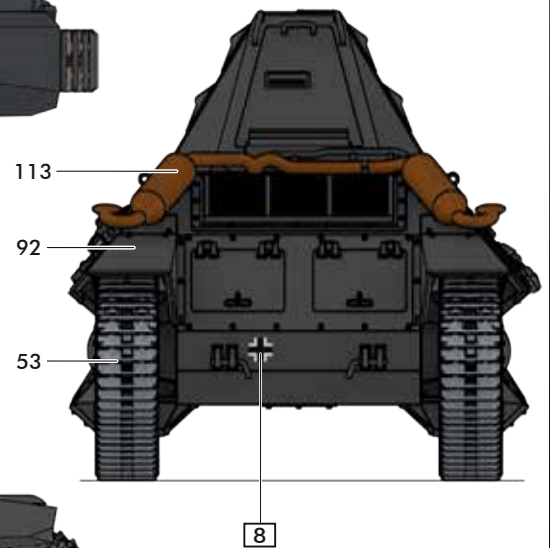
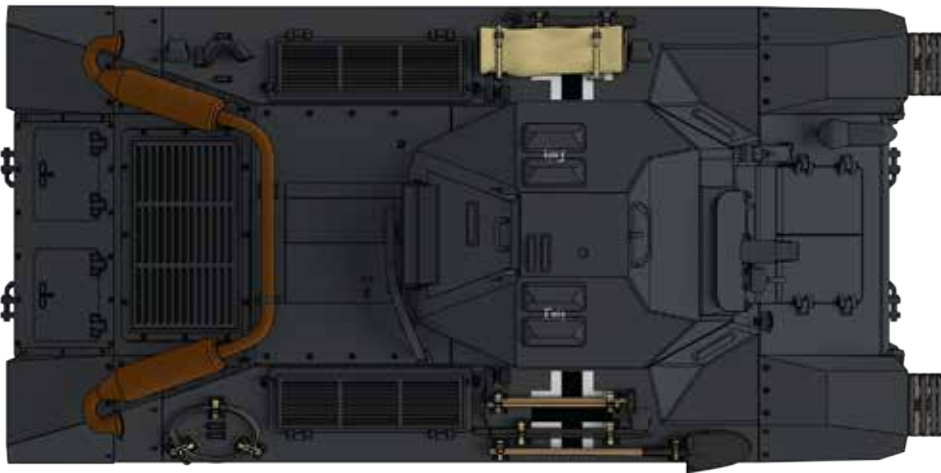
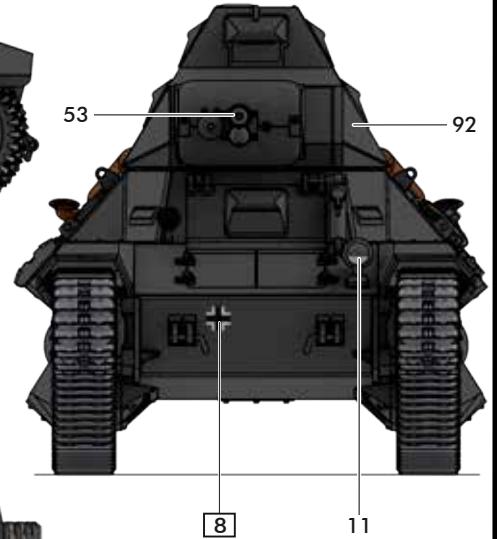
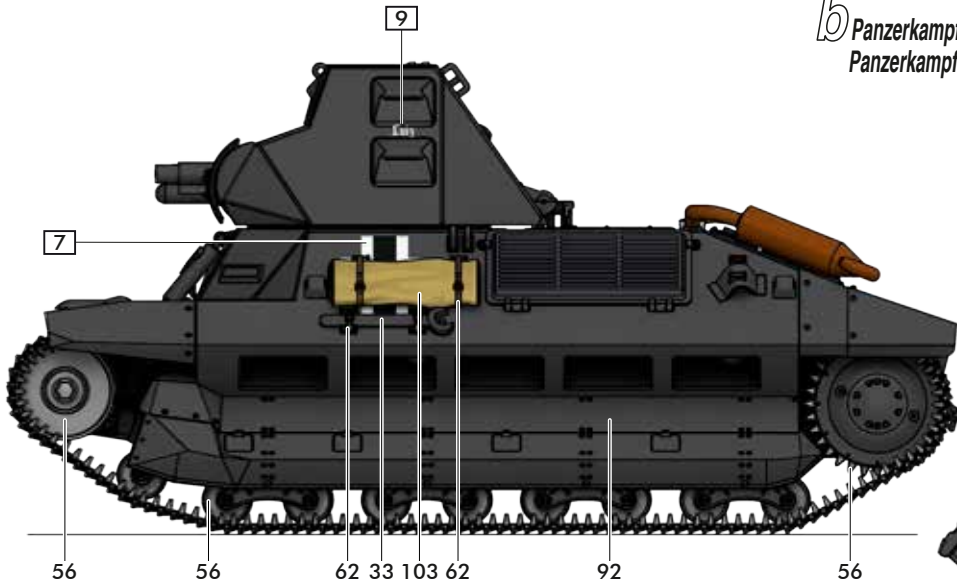

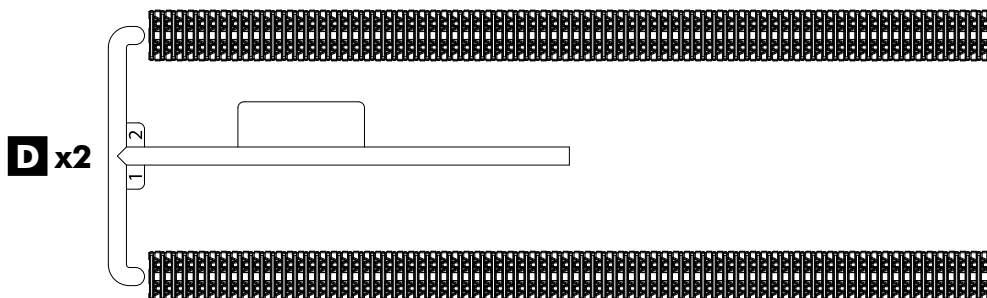
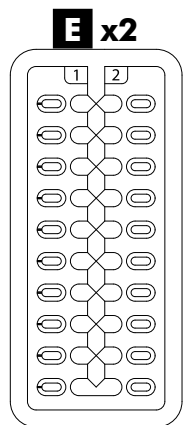
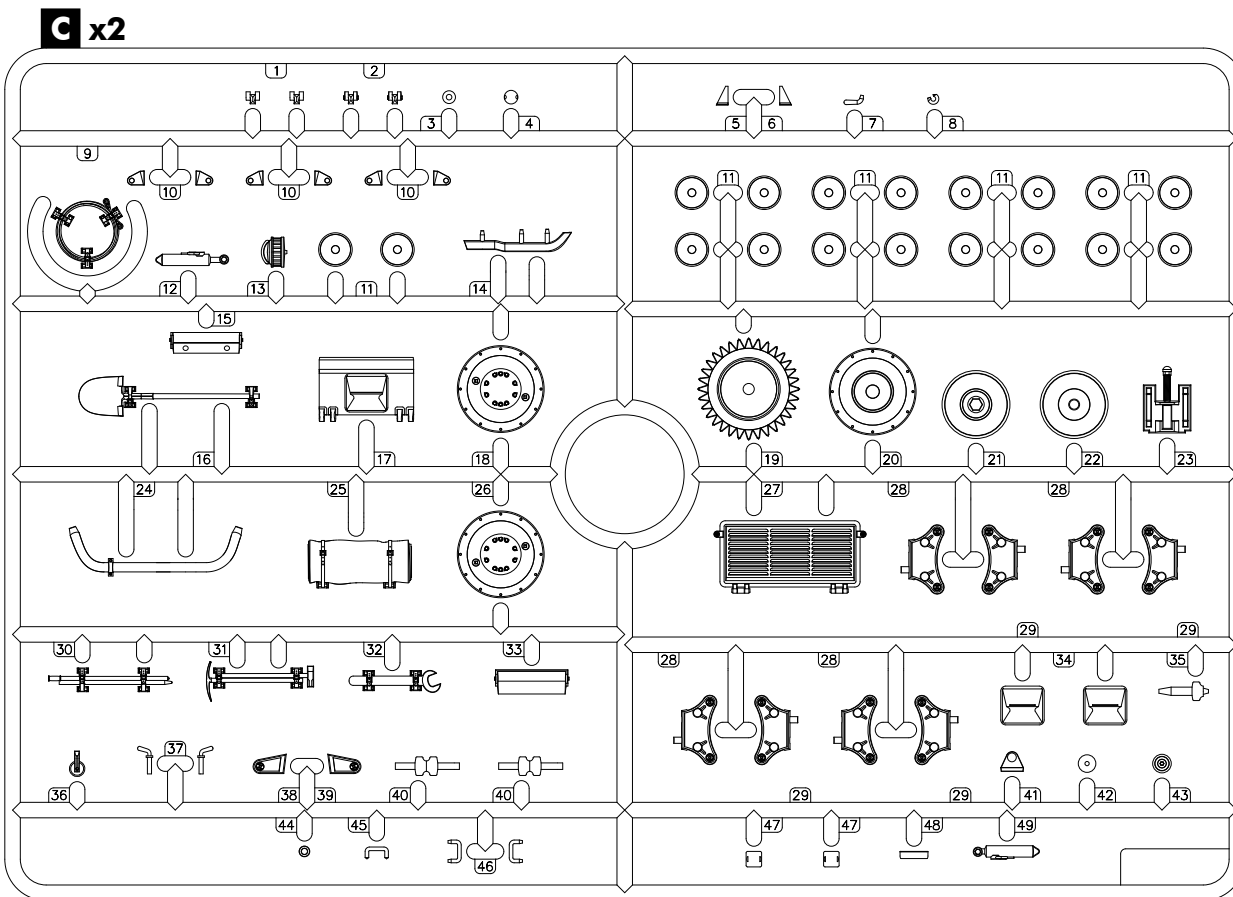
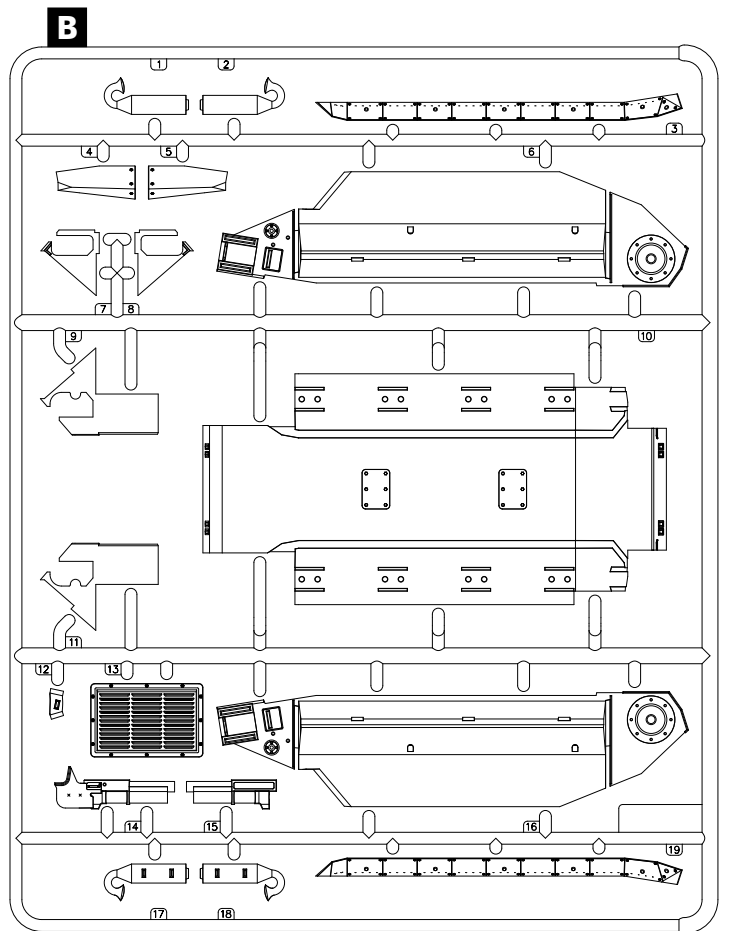
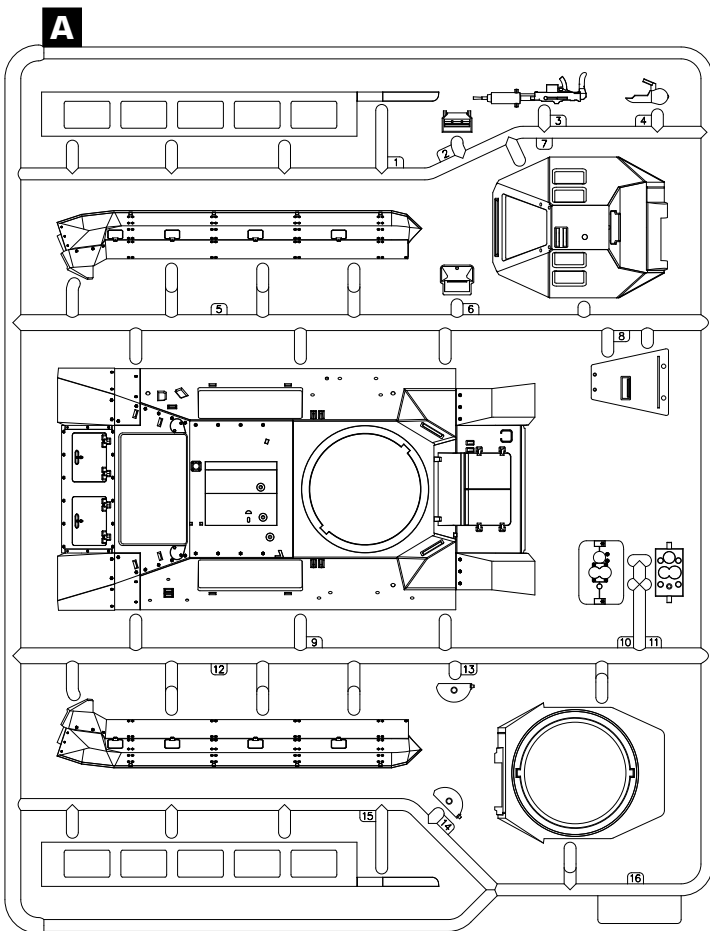

VISITEZ-NOUS SUR LES RÉSEAUX SOCIAUX

VISIT US ON SOCIAL MEDIA!
BESUCHEN SIE UNS AUF SOCIAL MEDIA!

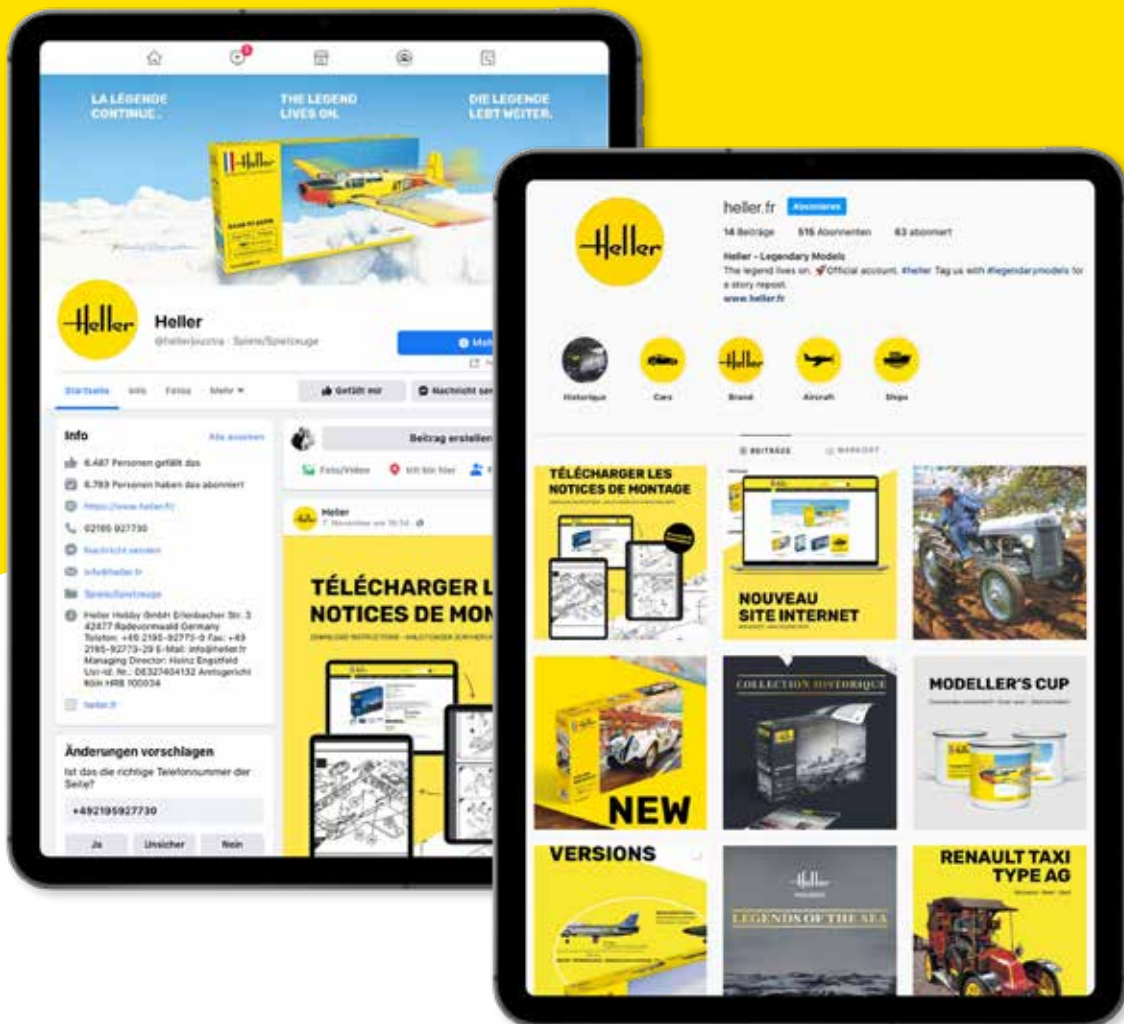

@instagram.com/heller.fr • facebook.com/heller.fr

VISITEZ-NOUS EN LIGNE !

VISIT US DIGITALLY!
BESUCHEN SIE UNS DIGITAL!

 www.heller.fr

 [instagram.com/heller.fr](https://www.instagram.com/heller.fr)

 [facebook.com/heller.fr](https://www.facebook.com/heller.fr)

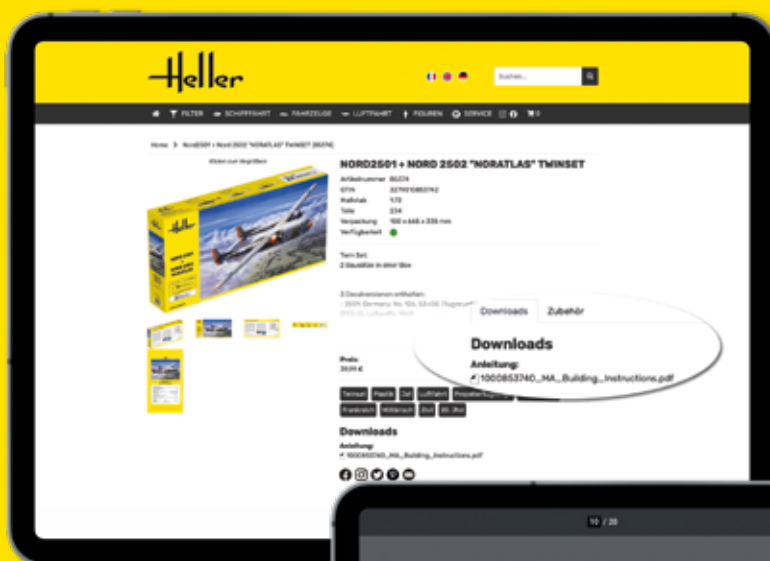

Choisissez l'article désiré et téléchargez la notice de montage.
Choose your desired article and download the instructions.
Wählen Sie den gewünschten Artikel und laden Sie die Anleitung herunter.

**Download all
instructions!**

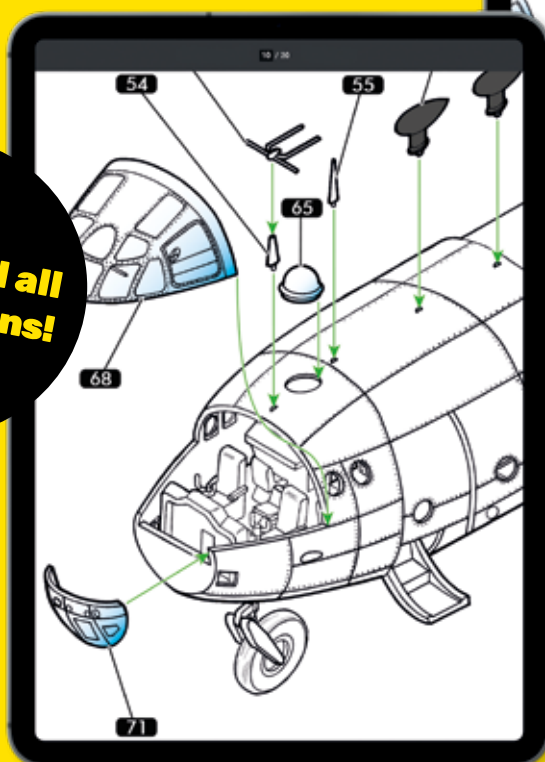

Grossissement des instructions pour
une vue détaillée.

Enlarge the instructions for a more
detailed view.

Vergrößern Sie die Anleitung für eine
detailliertere Ansicht.

V-161123

Service consommateurs
Pour toute demande de SAV, connectez-vous
sur notre site www.heller.fr.

Customer Service
For after-sales service requests,
please contact us through our website
www.heller.fr.

Endverbraucherservice
Bitte besuchen Sie uns auf www.heller.fr
für alle Ersatzteilanfragen.

Heller Hobby GmbH

Erlenbacher Str. 3 • 42477 Radevormwald • GERMANY

+49 (0) 2195-92773-0 info@heller.fr